

**CHOOSE
QUALITY
TAPWARE
THAT'S
HYGIENIC
AND
EASIER
TO USE.**



Lever Action Tapware

 **ENWARE**
AUSTRALIA PTY LIMITED



HYGIENIC LEVER ACTION TAPWARE FOR SUPERIOR OPERATION

Enware's Lever Action Tapware is a world leader for quality, simplicity and proven endurance. The functional designs – in sizes of 60mm, 100mm, 150mm and 200mm – make them perfect for applications in which ease of operation and control is paramount.

The versatility of wall or bench mounting makes them ideal for medical, surgical and laboratory use, as well as hygienic commercial food preparation. The simple lever action brings extra convenience for convalescent and retirement facilities; and especially for those with arthritis.

Each Lever Action tap is WaterMark licensed to AS/NZS 3718; created from durable, dezincification resistant brass for a long life. The easy action quarter-turn valve technology is available in standard ceramic disc, non-rising jumper valve; or in heavy pattern, rising jumper valve.

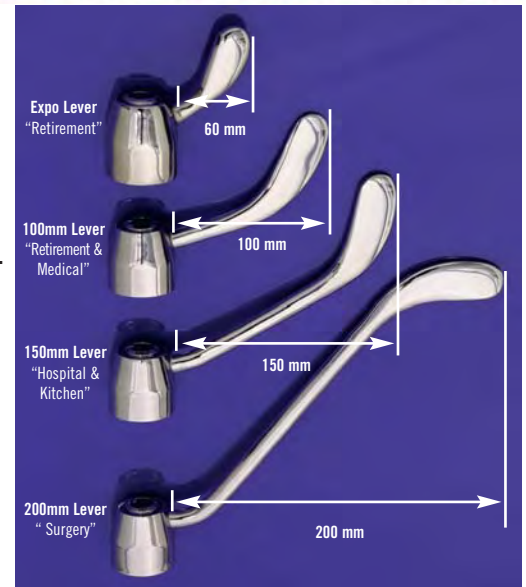

WELS Star rated to maximise water efficiency

Water wastage can account for a large percentage of consumption.

Enware's Anti-Vandal tapware helps by minimising the water wasted whilst still delivering a practical and comfortable service to the user.

- Predetermined flow rate minimises excessive water usage during normal use
- Enware's Lever Action tapware is WELS registered to deliver Basix, PIC and other regulatory authority compliances
- Showers are available in WELS 3 star 7.6 lpm only
- Hose taps, cistern taps, stop cocks and bath taps are exempt from WELS ratings
- Single Lever Mixers are supplied standard with a 4 star (7.0 lpm)

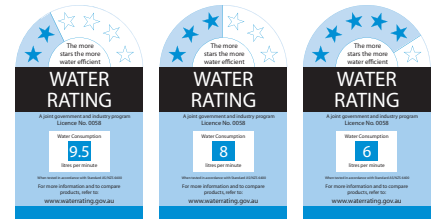

Enware's Lever Action tapware is supplied standard with a WELS 3 Star (7.7 lpm) water efficiency rating.

Also available in 2 (9.1 lpm) 3 (7.7 lpm) and 5 (5.6 lpm) Star ratings.

Options and Technical Information

Finishes:

The standard finish is a heavy duty bright Chrome Plate. Optional is a Satin Chrome finish or a range of colour powder coated finishes.

- **Satin Chrome:** Specify with order & use SC at the end of the code. Eg HOS401SC
- **Powder Coated:** Specify with order
- **For Colour Coated Handles only:** Specify with order
Note there are additional charges for non standard finishes.



Colour Indicators:

New standards for the delivery of warm water to ablutionary outlets in Australia means a Yellow indicator may be required. Check with local authorities for application requirements.

- **Red & Blue Buttons:** Standard with all tapware sets.
- **Yellow & Blue Buttons:** Request when specifying or placing orders.
- **Colour Coded Handles:** Specify colours required when specifying or placing orders.

For warm water delivery to ablutionary outlets under AS3500.4, choose from the Aquablend range of Thermostatic Mixing Valves.

Spouts and Outlet Attachments:

Enware offer a wide variety of Spouts and Shower Roses, please refer to our Outlets brochure, interactive CD-ROM, website or contact an Enware representative. Enware can also cater for special requests with our custom fabrication facilities.

Standard Valving Quarter Turn Ceramic Disc	Optional Valving Quarter Turn Jumper Valve Non-Rising	Optional Valving Quarter Turn Jumper Valve Rising	
Recommended Working Pressures/Temperature			
Ceramic Disc:	Minimum 50kPa	Maximum 800kPa	Maximum Temperature 75° C
Jumper Valve:	10kPa	1500kPa	95° C
For optimum performance hot and cold pressures should be equal.			

Index

TECHNICAL INFORMATION	2
EXPO TAPWARE	3
SINGLE LEVER MIXERS	6
HOSPITAL/MEDICAL TAPWARE	7
ASSOCIATED TAPWARE AND SAFETY PRODUCTS	11

Lever action tapware especially designed for hospitals and retirement/aged facilities

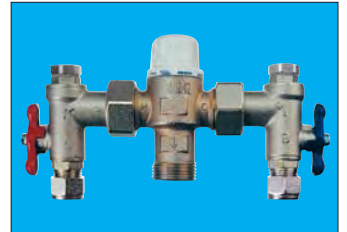

Aquablend TMV's deliver warm water to a safe pre-set temperature

EXPO

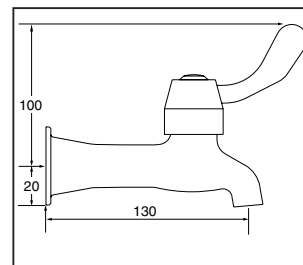
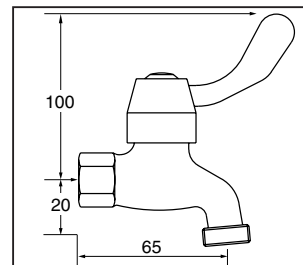
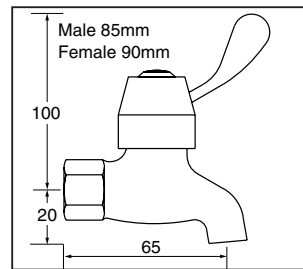
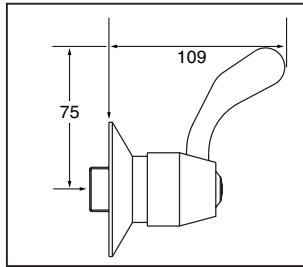
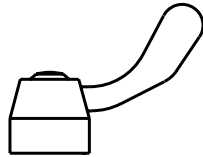

Description

Code

Expo Single Recess Adaptor (Wall)

Ceramic Disc
Jumper Valve Non-Rising

EX308
EXN308

Expo Bib Tap 15mm

Ceramic Disc
Jumper Valve Non-Rising

EX301M EX301F
EXN301M EXN301F

With Ablution Outlet

Ceramic Disc
Jumper Valve Non-Rising

EX312M EX312F
EXN312M EXN312F

With Aerated Outlet

Ceramic Disc
Jumper Valve Non-Rising

EX325M EX325F
EXN325M EXN325F

*WELS 3 Star (7.7 lpm) water efficiency rating supplied as standard.
Also available in 2 (9.1 lpm) 5 (5.6 lpm) Star ratings*

Expo Hose Tap 15mm

Ceramic Disc
Jumper Valve Non-Rising

EX305M EX305F
EXN305M EXN305F

Expo Bib Tap 50mm

Extended Female 15mm

Ceramic Disc
Jumper Valve Non-Rising

EX321F
EXN321F

With Ablution Outlet

Ceramic Disc
Jumper Valve Non-Rising

EX333F
EXN333F

With Aerated Outlet

Ceramic Disc
Jumper Valve Non-Rising

EX322F
EXN322F

*WELS 3 Star (7.7 lpm) water efficiency rating supplied as standard.
Also available in 2 (9.1 lpm) 5 (5.6 lpm) Star ratings*

EXPO

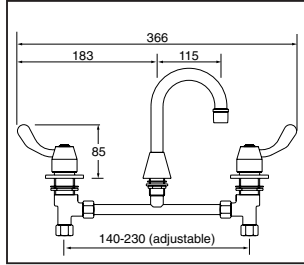
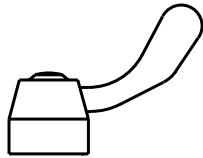

Description

Code

Expo Basin Set

With SP001 Fixed Aerated Spout
Adjustable width 140 – 230mm

Ceramic Disc EX306
Jumper Valve Non-Rising EXN306

*WELS 3 Star (7.7 lpm) water efficiency rating supplied as standard.
Also available in 2 (9.1 lpm) 5 (5.6 lpm) Star ratings*

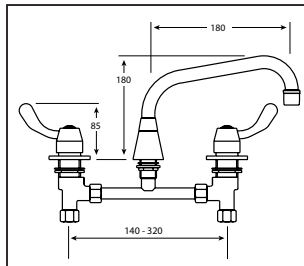

Expo Sink Set

With SP010 Swivel Aerated Spout
Adjustable width 140 – 320mm

Ceramic Disc EX307
Jumper Valve Non-Rising EXN307

*WELS 3 Star (7.7 lpm) water efficiency rating supplied as standard.
Also available in 2 (9.1 lpm) 5 (5.6 lpm) Star ratings*

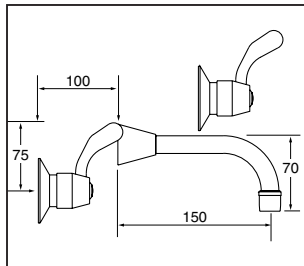

Expo Wall Set

With SP201 Fixed Aerated Bath Spout

Ceramic Disc EX314
Jumper Valve Non-Rising EXN314

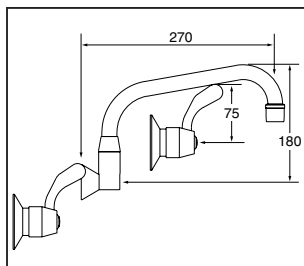
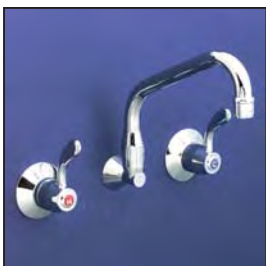

Expo Wall Set

With SP110 Swivel Aerated Spout

Ceramic Disc EX315
Jumper Valve Non-Rising EXN315

*WELS 3 Star (7.7 lpm) water efficiency rating supplied as standard.
Also available in 2 (9.1 lpm) 5 (5.6 lpm) Star ratings*

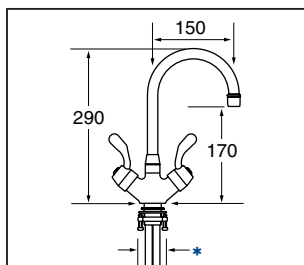

Expo Dual Mixer

With SP020 Swivel Aerated Spout

Ceramic Disc EX370
Jumper Valve Non-Rising EXN370

*1/2" BSP Female inlets
and 350mm flexible hoses
Bench hole 32mm Ø

*WELS 3 Star (7.7 lpm) water efficiency rating supplied as standard.
Also available in 2 (9.1 lpm) 5 (5.6 lpm) Star ratings*

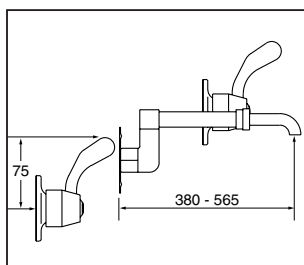

Expo Wall Set

With SP251 Extendible Laundry Arm

Ceramic Disc EX347
Jumper Valve Non-Rising EXN347

*WELS 3 Star (7.7 lpm) water efficiency rating supplied as standard.
Also available in 2 (9.1 lpm) 5 (5.6 lpm) Star ratings*

EXPO

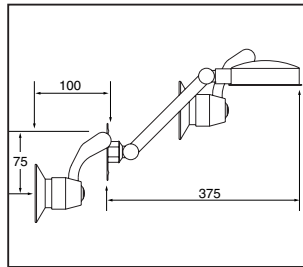
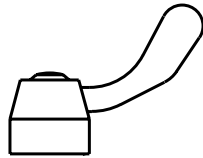

Description

Code

Expo Recessed Shower Set

With SP263 All Directional Shower

Ceramic Disc
Jumper Valve Non-Rising

EX349
EXN349

Also available

Expo Recessed Shower Set

With VP310 Anti Vandal Shower

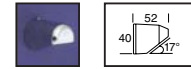

Ceramic Disc
Jumper Valve Non-Rising

EX354
EXN354

WELS 3 Star (7.6 lpm) water efficiency rating supplied as standard.

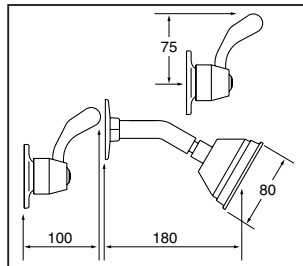

Expo Recessed Shower Set

With SP261 80mm Ball Joint
Shower Rose

Ceramic Disc
Jumper Valve Non-Rising

EX316
EXN316

WELS 3 Star (7.6 lpm) water efficiency rating supplied as standard.

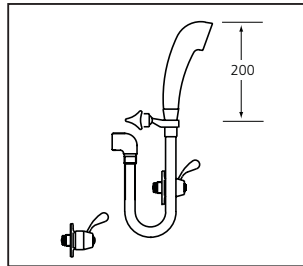

Expo Shower Set

With SP272 Hand Held Shower
and 1.5 metre Hose

Ceramic Disc
Jumper Valve Non-Rising

EX361
EXN361

WELS 3 Star (7.6 lpm) water efficiency rating supplied as standard.

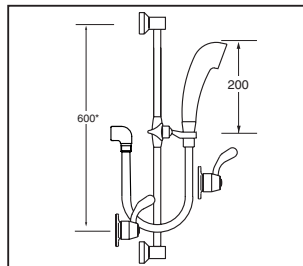
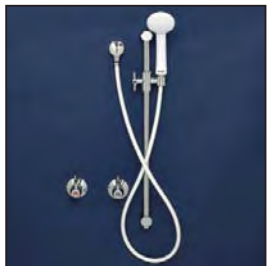

Expo Shower Set

With SP273 Hand Held Shower,
1.5m Hose and Wall bar*

Ceramic Disc
Jumper Valve Non-Rising

EX363
EXN363

*Wall bar is 600mm but
adjustable on installation

WELS 3 Star (7.6 lpm) water efficiency rating supplied as standard.

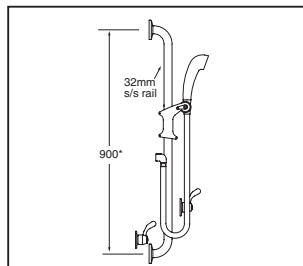
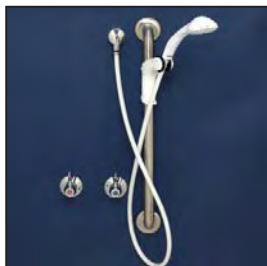

Expo Shower Set

With SGR012 900mm Grab Rail,*
Hand Held Shower and 1.5m Hose

Ceramic Disc
Jumper Valve Non-Rising

EX364
EXN364

*Grab Rails also available in 300mm
and 600mm

WELS 3 Star (7.6 lpm) water efficiency rating supplied as standard.

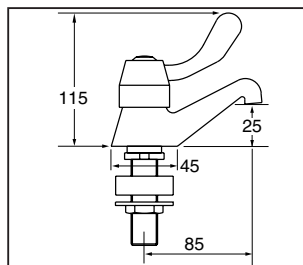
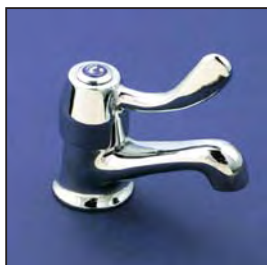

Expo Pillar Tap 15mm

Ceramic Disc
Jumper Valve Non-Rising

EX302
EXN302

With Ablution Outlet

Ceramic Disc
Jumper Valve Non-Rising

EX337
EXN337

With Aerated Outlet

Ceramic Disc
Jumper Valve Non-Rising

EX327
EXN327

*WELS 3 Star (7.7 lpm) water efficiency rating supplied as standard.
Also available in 2 (9.1 lpm) 5 (5.6 lpm) Star ratings*

EXPO

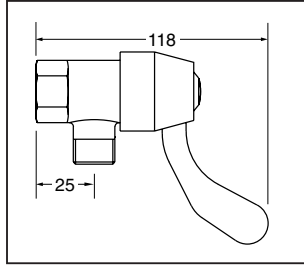
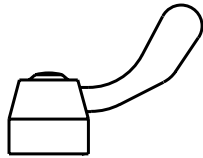

Description

Expo Right Angle Cistern Tap 15mm

Ceramic Disc
Jumper Valve Non-Rising

Code

EX303
EXN303

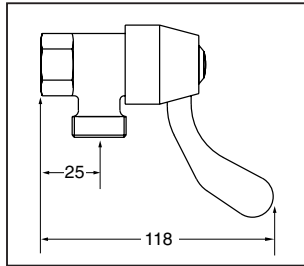

Expo Washing Machine Tap

Ceramic Disc
Jumper Valve Non-Rising

EX313
EXN313

SINGLE LEVER MIXERS

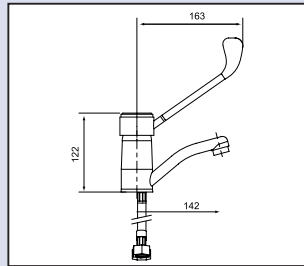

Description

Single Lever Disabled Basin Mixer

Code

SLM 306D

*WELS 4 Star (7.0 lpm) water efficiency rating supplied as standard.
Also available in 2 Star (9.1 lpm) and 3 Star (7.7 lpm) ratings*

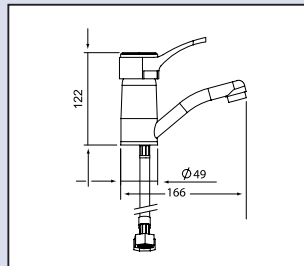

Single Lever Basin Mixer

SLM 306

*WELS 4 Star (7.0 lpm) water efficiency rating supplied as standard.
Also available in 2 Star (9.1 lpm) and 3 Star (7.7 lpm) ratings*

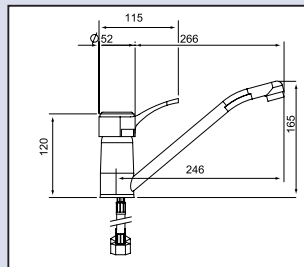

Single Lever Sink Mixer

SLM 307

*WELS 4 Star (7.0 lpm) water efficiency rating supplied as standard.
Also available in 2 Star (9.1 lpm) and 3 Star (7.7 lpm) ratings*



Single Lever Recess Mixer for Baths or Showers SLM 308

For a wide range of WELS registered water efficient outlets and shower heads, refer to Enware's Outlets brochure.

HOSPITAL

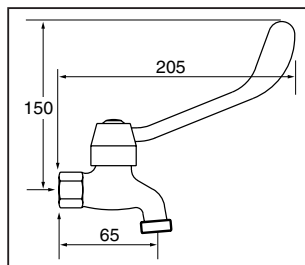
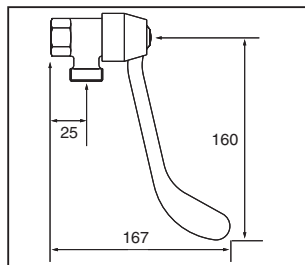
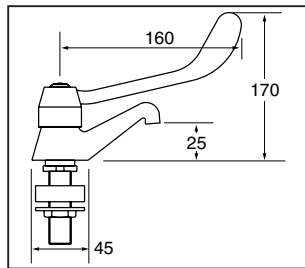
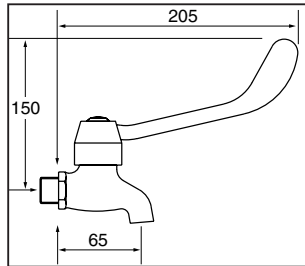
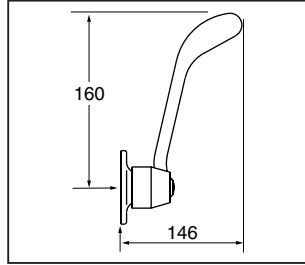
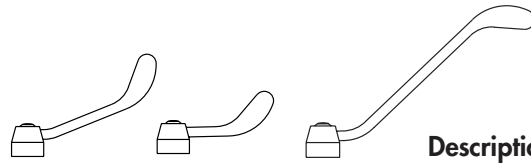

Description

Lever Single Recess Adaptor (Wall)

Ceramic Disc HOS308
Jumper Valve Rising JHS308

Code
150mm
Lever

Code
100mm
Lever

Code
200mm
Lever

HNS308
JNS308

HPS308
JPS308

Lever Bib Tap 15mm

Ceramic Disc Male HOS301M
Ceramic Disc Female HOS301F
Jumper Valve Rising Male JHS301M
Jumper Valve Rising Female JHS301F

HOS301M
HOS301F
JHS301M
JHS301F

HN301M
HN301F
JNS301M
JNS301F

HPS301M
HPS301F
JPS301M
JPS301F

With Ablution Outlet

Ceramic Disc Male HOS312M
Ceramic Disc Female HOS312F
Jumper Valve Rising Male JHS312M
Jumper Valve Rising Female JHS312F

HOS312M
HOS312F
JHS312M
JHS312F

HNS312M
HNS312F
JNS312M
JNS312F

HPS312M
HPS312F
JPS312M
JPS312F

With Aerated Outlet

Ceramic Disc Male HOS325M
Ceramic Disc Female HOS325F
Jumper Valve Rising Male JHS325M
Jumper Valve Rising Female JHS325F

HOS325M
HOS325F
JHS325M
JHS325F

HNS325M
HNS325F
JNS325M
JNS325F

HPS325M
HPS325F
JPS325M
JPS325F

*WELS 3 Star (7.7 lpm) water efficiency rating supplied as standard.
Also available in 2 (9.1 lpm) 5 (5.6 lpm) Star ratings*

Lever Pillar Tap 15mm

Ceramic Disc HOS302
Jumper Valve Rising JHS302

HOS302
JHS302

HNS302
JNS302

HPS302

With Ablution Outlet

Ceramic Disc HOS337
Jumper Valve Rising JHS337

HOS337
JHS337

HNS337
JNS337

HPS337

With Aerated Outlet

Ceramic Disc HOS327
Jumper Valve Rising JHS327

HOS327
JHS327

HNS327
JNS327

HPS327

WELS 3 Star (7.7 lpm) water efficiency rating supplied as standard. Also available in 2 (9.1 lpm) 5 (5.6 lpm) Star ratings

Lever Washing Machine Tap

Ceramic Disc HOS313
Jumper Valve Rising JHS313

HOS313
JHS313

HNS313
JNS313

HPS313

Lever Hose Tap 15mm

Ceramic Disc Male HOS305M
Ceramic Disc Female HOS305F
Jumper Valve Rising Male JHS305M
Jumper Valve Rising Female JHS305F

HOS305M
HOS305F
JHS305M
JHS305F

HNS305M
HNS305F
JNS305M
JNS305F

HPS305M
HPS305F
JPS305M
JPS305F

HOSPITAL

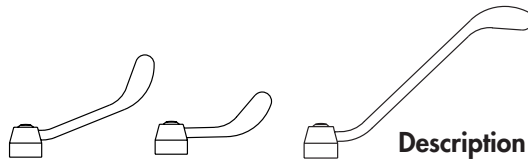

Description

Code
150mm
Lever

Code
100mm
Lever

Code
200mm
Lever

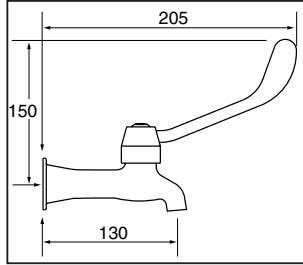

Lever Bib Tap 50mm

Extended Female 15mm

Ceramic Disc
Jumper Valve Rising

HOS321F
JHS321F

HNS321F
JNS321F

HPS321F

*WELS 3 Star (7.7 lpm) water efficiency rating supplied as standard.
Also available in 2 (9.1 lpm) 5 (5.6 lpm) Star ratings*

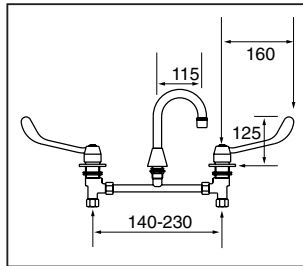

Lever Adjustable Basin Set

With SP001 Fixed Aerated Spout

Ceramic Disc
Jumper Valve Rising

HOS306
JHS306

HNS306
JNS306

HPS306
JPS306

Adjustable width 140 - 230mm

*WELS 3 Star (7.7 lpm) water efficiency rating supplied as standard.
Also available in 2 (9.1 lpm) 5 (5.6 lpm) Star ratings*

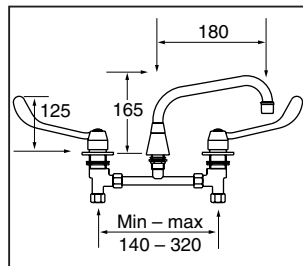
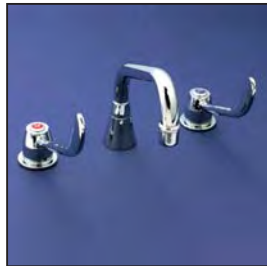

Lever Forward Bowl Sink Set

With SP010 Swivel Aerated Spout

Ceramic Disc
Jumper Valve Rising

HOS307
JHS307

HNS307
JNS307

HPS307
JPS307

Adjustable width 140 - 320mm

*WELS 3 Star (7.7 lpm) water efficiency rating supplied as standard.
Also available in 2 (9.1 lpm) 5 (5.6 lpm) Star ratings*

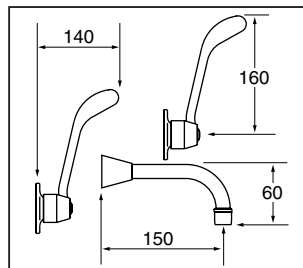
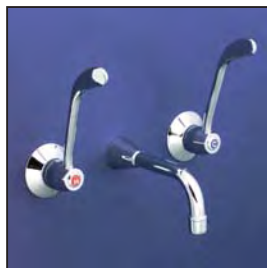

Lever Wall Set

With SP201 Fixed Aerated Bath Spout

Ceramic Disc
Jumper Valve Rising

HOS314
JHS314

HNS314
JNS314

Lever Wall Set

With SP110 Swivel Aerated Spout

Ceramic Disc
Jumper Valve Rising

HOS315
JHS315

HNS315
JNS315

*WELS 3 Star (7.7 lpm) water efficiency rating supplied as standard.
Also available in 2 (9.1 lpm) 5 (5.6 lpm) Star ratings*

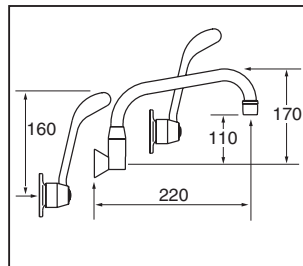

HOSPITAL

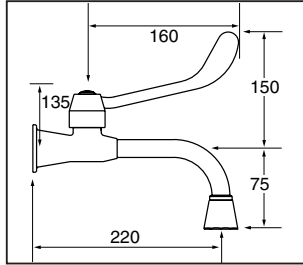
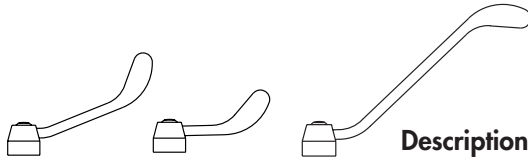

Description

Type 54 Fixed Outlet

For Pre-Mixed Water

Ceramic Disc Jumper Valve Rising
HOS403
JHS403

Code
150mm
Lever

Code
100mm
Lever

Code
200mm
Lever

HNS403
JNS403

HPS403
JPS403

*WELS 3 Star (7.7 lpm) water efficiency rating supplied as standard.
Also available in 2 (9.1 lpm) 5 (5.6 lpm) Star ratings*

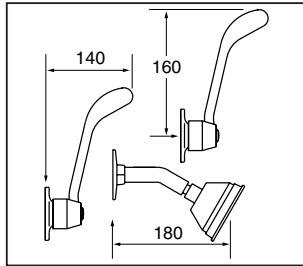

Lever Shower Set

With SP261 80mm Ball Joint Shower

Ceramic Disc Jumper Valve Rising
HOS316
JHS316

HNS316
JNS316

WELS 3 Star (7.6 lpm) water efficiency rating supplied as standard.

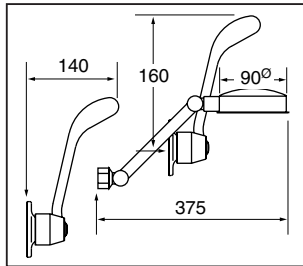

Lever Shower Set

With SP263 All Directional Shower

Ceramic Disc Jumper Valve Rising
HOS349
JHS349

HNS349
JNS349

Also available with
VP310 Anti Vandal Shower

Ceramic Disc Jumper Valve Rising
HOS354
JHS354

HNS354
JNS354

WELS 3 Star (7.6 lpm) water efficiency rating supplied as standard.

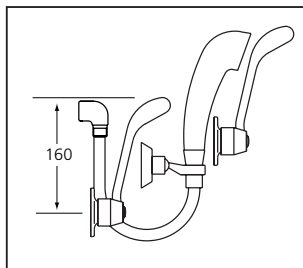
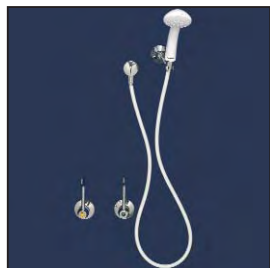

Lever Shower Set

With SP272 Hand Held Shower
and 1.5 metre Hose

Ceramic Disc Jumper Valve Rising
HOS361
JHS361

HNS361
JNS361

WELS 3 Star (7.6 lpm) water efficiency rating supplied as standard.

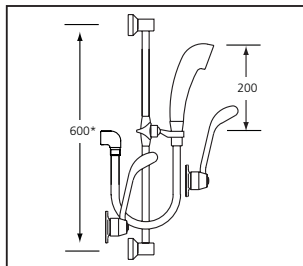
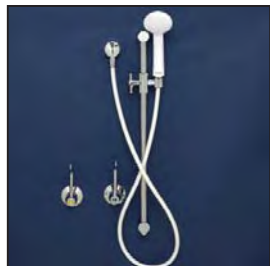

Lever Shower Set

With SP272 Hand Held Shower
and 1.5 metre Hose and Wall bar*

Ceramic Disc Jumper Valve Rising
HOS363
JHS363

HNS363
JNS363

*Wall bar is 600mm in length
but adjustable on installation

WELS 3 Star (7.6 lpm) water efficiency rating supplied as standard.

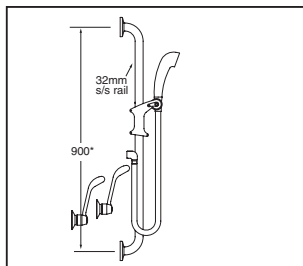
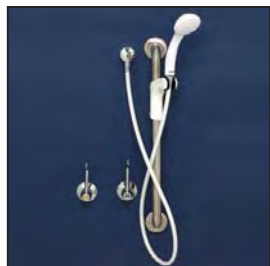

Lever Shower Set

With SGR012 Grab Rail,* SP272 Hand
Held Shower and 1.5 metre Hose

Ceramic Disc Jumper Valve Rising
HOS364
JHS364

HNS364
JNS364

*Grab Rails also Available in 300 and 600mm

WELS 3 Star (7.6 lpm) water efficiency rating supplied as standard.

HOSPITAL

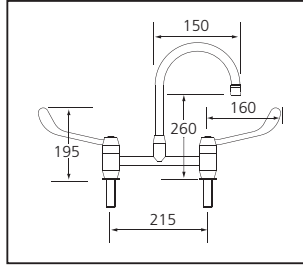
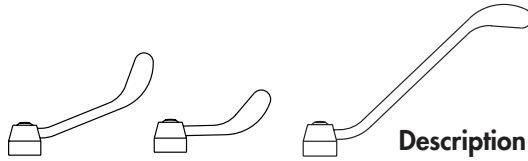

Description

Type 50 Hob Mounted Mixing Set with SP021

With Fixed Centres 215mm and Swivel Outlet

Ceramic Disc HOS401
Jumper Valve Rising JHS401

Code
150mm
Lever

Code
100mm
Lever

Code
200mm
Lever

HNS401
JNS401

HPS401
JPS401

*WELS 3 Star (7.7 lpm) water efficiency rating supplied as standard.
Also available in 2 (9.1 lpm) 5 (5.6 lpm) Star ratings*

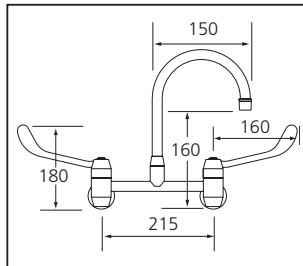

Type 51 Wall Mounted Mixing Set with SP020

With Fixed Centres 215mm and Swivel Outlet

Ceramic Disc HOS402
Jumper Valve Rising JHS402

HNS402
JNS402

HPS402
JPS402

*WELS 3 Star (7.7 lpm) water efficiency rating supplied as standard.
Also available in 2 (9.1 lpm) 5 (5.6 lpm) Star ratings*

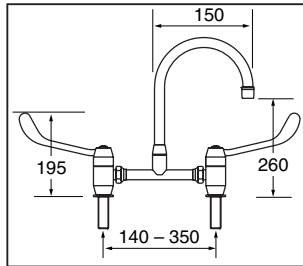

Type 50 Hob Mounted Mixing Set with SP021

With Adjustable Centres 140 – 350mm and Swivel Outlet

Ceramic Disc HOS421
Jumper Valve Rising JHS421

HNS421
JNS421

HPS421
JPS421

*WELS 3 Star (7.7 lpm) water efficiency rating supplied as standard.
Also available in 2 (9.1 lpm) 5 (5.6 lpm) Star ratings*

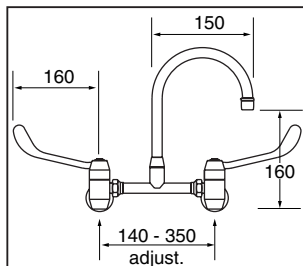

Type 51 Wall Mounted Mixing Set with SP020

With Adjustable Centres 140 – 350mm and Swivel Outlet

Ceramic Disc HOS422
Jumper Valve Rising JHS422

HNS422
JNS422

HPS422
JPS422

*WELS 3 Star (7.7 lpm) water efficiency rating supplied as standard.
Also available in 2 (9.1 lpm) 5 (5.6 lpm) Star ratings*

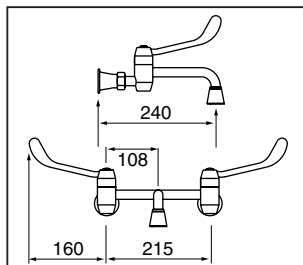

Type 56 Wall Mounted Mixing Set

With Fixed Outlet

Ceramic Disc HOS420
Jumper Valve Rising JHS420

HNS420
JNS420

*WELS 3 Star (7.7 lpm) water efficiency rating supplied as standard.
Also available in 2 (9.1 lpm) 5 (5.6 lpm) Star ratings*

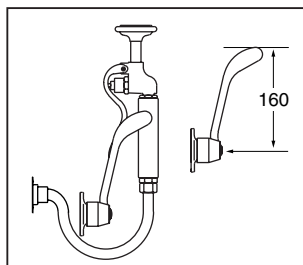

Lever Recessed Set

With FS721 Spray with 1 Metre Hose and Stainless Steel Wall Bracket

Ceramic Disc HOS365

HNS365

*WELS 3 Star (7.7 lpm) water efficiency rating supplied as standard.
Also available in 2 (9.1 lpm) 5 (5.6 lpm) Star ratings*

HOSPITAL

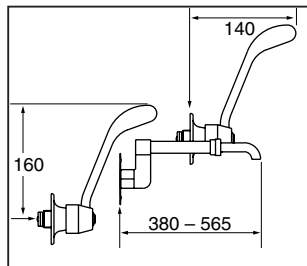
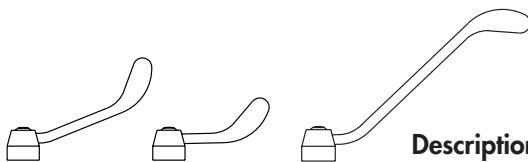

Description

Lever Wall Set

With SP251 Telescopic Laundry Arm
Ceramic Disc
Jumper Valve Rising

**Code
150mm
Lever**

HOS347
JHS347

**Code
100mm
Lever**

HNS347
JNS347

**Code
200mm
Lever**

WELS 3 Star (7.7 lpm) water efficiency rating supplied as standard. Also available in 2 (9.1 lpm) 5 (5.6 lpm) Star ratings

Specialist Tapware and Safety Products

Aquablend TMVs: The safe way to mix water to a pre-set temperature.



Aquablend Thermostatic Mixing Valves are Australian made, simple and easy to maintain, Standards marked to AS/NZS4032 - and provide many features that not only match but exceed industry standards. A summary of their proven benefits includes:

Scald protection

The thermal shut-off capability delivers immediate shutdown of the valve in the event of hot or cold water supply failure. The valve will reinstate itself when normal supply resumes.

Constant mix control

Water temperature is maintained at plus or minus 2 degrees, even during water temperature or pressure fluctuations.

Easy maintenance

The compact cartridge-style assembly allows low-cost, in-situ servicing and ensures minimum down-time.

Supplied complete

Each unit comes complete with combination isolating ball valve, non-return and dual-stage strainer assemblies which incorporate water pressure/temperature test ports.



Commercial Laboratory Tapware

Enware manufacture an extensive range of high quality, Australian made laboratory tapware including RO water, gas and dry media fittings.

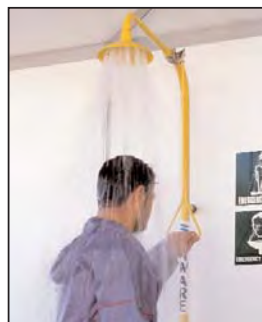

Safety Solutions

Enware manufacture a wide variety of Deluge Showers and Emergency Eyewash Equipment. Also available is the Fendall range of portable eyewash equipment.



Food Service Tapware

Enware manufacture an extensive range of pre-rinse assemblies for commercial kitchens. The range is interchangeable with pot fillers.



Hands Free Tapware

Enware offers a comprehensive selection of sensor operated tapware as well manual systems such as Knee and Foot operated.

LEADING ORGANISATIONS CHOOSE ENWARE

Enware's award winning tapware is appreciated for its style, function, uncompromised quality and price. That's why it's chosen by these leading Australian and international companies:

FOOD SERVICE

McDonald's Restaurants
Coles Supermarkets
QANTAS Catering
Woolworths Australia
Hungry Jacks Restaurants
Primo Meats
Star Bucks

INDUSTRY

WMC Olympic Dam Expansion, SA
Hewlett Packard, Penang
ORICA, Chlor-Alkali Plants NSW/VIC
Pasminco Century Zinc Mine, QLD
Nestle, Indonesia
Unilever, Indonesia
Caltex, Malaysia
Motorola, Malaysia
BASF, Philippines
Chartered Semi Conductor, Singapore
QANTAS, Sydney International Airport
Shell Refinery, New Guinea

LABORATORIES

CSIRO Joint Research Facility, NSW
CSIRO Research, VIC
Childrens Medical Research Foundation
National Marine Science Labs
Westmead Hospital Medial Research
Johnson & Johnson
Hunter Water Laboratory
Coca Cola Laboratories, Indonesia
Astra Pharmaceuticals
Canberra University
CSIRO Western Australia
CSIRO/Uni. of Qld Joint Facility, QLD

DETENTION CENTRES

Long Bay Gaol, NSW
Honiara Gaol, PNG
Goulburn Detention Centre, NSW
Parklea Remand Centre, NSW
Bandyup Prison, WA
Dillwynia Correctional Centre
Dubai Prison

HOSPITALS

St Vincents Hospital, Sydney
Royal Brisbane Hospital
Royal Adelaide Hospital
St Andrews, Brisbane
Royal Prince Alfred Hospital
Royal Dental Hospital, VIC
Darwin Hospital
John Hunter Hospital
Auckland Hospital, NZ
Kuala Lumpur Private Hospital

UNIVERSITIES

Melbourne University, Chemistry &
Biology Buildings
Sydney University
University of NSW
RMIT-Royal Melbourne Institute of
Technology
Australian National University, ACT
Edith Cowan University, WA
University of South Pacific, W. Samoa

SPECIALIST TAPWARE Commercial, Industrial, Hospitals, Schools, Laboratories, Anti-vandal, Food service
SAFETY & ENVIRONMENTAL SYSTEMS Deluge showers, Emergency eyewashes, Spill containment products
SPECIALIST WATER SYSTEMS Thermostatic mixing valves, Electronic tapware, Flush valves, Flow regulation
APPLIANCES Water chillers, Boiling water units, Hand hygiene systems
BATHROOM CARE Specialised adjustable Shower chairs, Support arms, Toilet seats, Basin supports, Grab rails
DISTRIBUTED BY:



ACN 003 988 314

9-11 Endeavour Road, Caringbah, NSW 2229 Australia

P.O. Box 2545 Taren Point NSW 2229

Ph: 61-2- 9525 9511 Fax: 61-2- 9525 9536

Toll Free Phone 1800 671 864

www.enware.com.au

e-mail: enware@enware.com.au



WaterMark

AS/NZS 3718 WMKA 1583
AS/NZS 3662 WMKA 21164
Standards Australia



**Quality
Endorsed
Company**

ISO 9001 Lic 1213
Standards Australia