

Supaslat

# MAXI BEAM

Lightweight Beam System



- Simple, bold and attractive
- Lightweight, rigid & no twisting
- Environmentally preferable
- *Now more adaptable than ever before!*

Supaslat

# MAXI BEAM



## Lightweight Beam System

*Beams that provide maximum impact while being quick and simple to specify and install!*

### ✓ Lightweight

Supaslat MAXI BEAM weighs only around 2kg/LM for a 200mm deep beam. This relieves the support structure of undue load and obviates the need for specially engineered framing.

### ✓ Dimensional Stability

Supaslat MAXI BEAM will not warp or twist as experienced with solid timber. The honeycomb core provides extreme rigidity, impact resistance and facilitates increased cantilevers.

### ✓ Acoustics

Supaslat MAXI BEAM is in itself acoustically diffusive, acting as a baffle. Acoustic absorption can be achieved by installing the beams under a perforated SUPACOUSTIC ceiling or SUPABAB black acoustic backing boards. Refer to Supawood for detailed drawings of backing options.

### ✓ Fixing Methods

Supaslat MAXI BEAM's proprietary fixing systems include fixing cleats and installation instructions to suit fixing to an open suspended frame, a suspended ceiling, walls or as a screen from floor to ceiling. Engineering certification is provided for the ceiling fixing system.

### ✓ Now as Adaptable as your Imagination

In response to customer requests we have been making Supaslat MAXI BEAMS more adaptable than ever:

- ▶ Tailor-made shaping
- ▶ Integrated lighting
- ▶ More finish choices
- ▶ Finishes to match panels and slats
- ▶ Extra large size beams
- ▶ Longer unsupported spans
- ▶ Fire Retardant options

Whatever your imagination desires... just ask! We've almost certainly done it before and can advise on adapting



*View our MAXI BEAM video...*

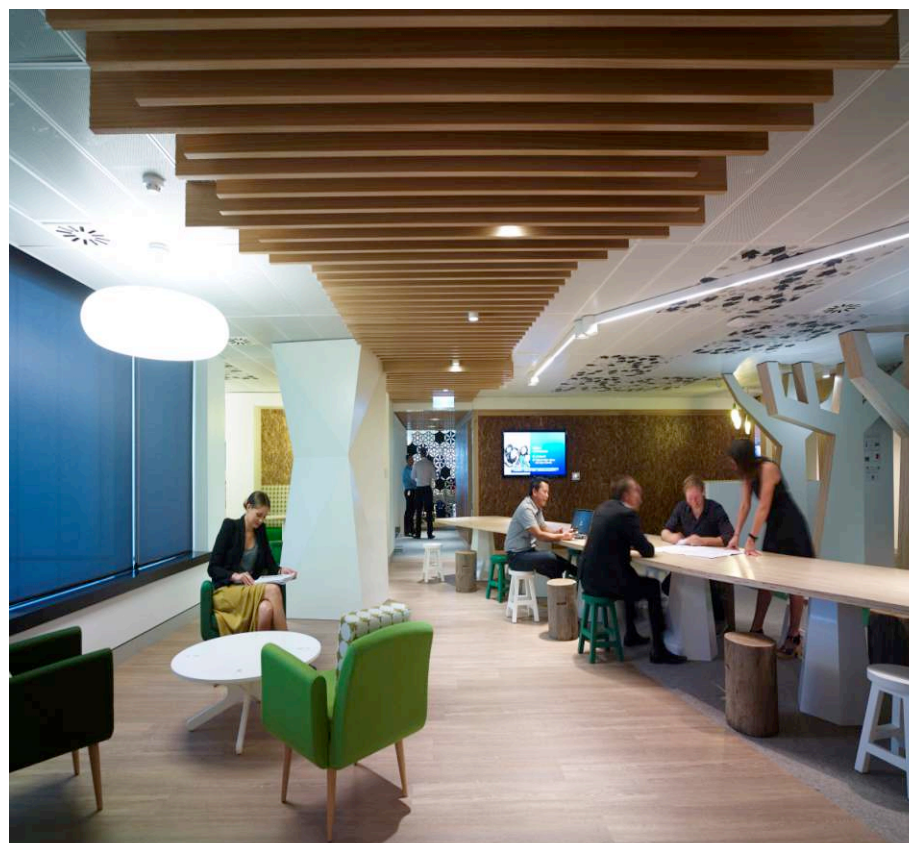

**Front Cover:**

Staggered SUPALAMI Light Tasmanian Oak laminate ceiling features and screens in the members' areas at Ascot Racecourse, Perth WA.

**Previous page from top:**

Supaslat MAXI BEAM under SUPACOUSTIC panels create a warm atmosphere and the quiet required in the learning centre library at Greenslopes Hospital, Greenslopes QLD.

SUPAVENEER Blackwood beams used as a suspended floating ceiling and wall screen to create a striking statement in the entrance of NSW Lifesaving HQ, Belmore NSW.

SUPAFINISH Tasmanian Oak concept veneer beams define the staff breakout area at Tarong Energy, Brisbane QLD.

**This page:**

*Top* - SUPALAMI Limed Poplar laminate in custom sizes forms an interesting ceiling feature at Ocean Keys Shopping Centre, Clarkson WA.

*Bottom left* - SUPALAMI White and SUPAVENEER Tasmanian Oak beams form a path through an area of Nathan Lion HQ, Homebush NSW.

*Bottom right* - SUPAVENEER Tasmanian Oak beams form a feature in a collaborative workspace at Nathan Lion HQ, Homebush NSW.

# Finish Options

## SUPALAMI (SL) Laminates

The Supalami range of laminate finishes is the most economical option and includes a large range of textured options.



Light Tas Oak SL



Rustic Oak SL

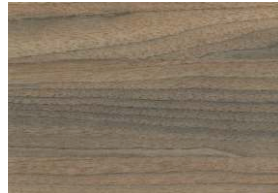

Brown Walnut SL



White 2000 SL



Rustic White SL



Striped Mahogany SL



Rustic Black SL

## SUPAVENEER (NTV) Natural Timber Veneer

These species are shown to get you started. SUPAWOOD can supply any species you may find from a Briggs or any other veneer supplier. We can also make recommendations on similar veneers that may be more affordable for value management.



Hoop Pine CC



Tasmanian Oak 1/4



Blackbutt 1/4

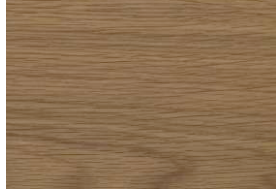

American Oak CC

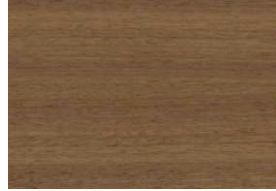

Spotted Gum 1/4



American Walnut CC



Midnight Black

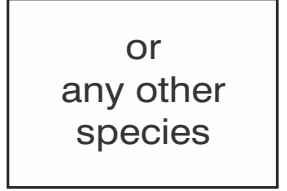

Your choice

## SUPAFINISH (SF) Concept Veneers & Colours

The SUPAFINISH range of concept veneers provides maximum flexibility of size. SUPAFINISH offers perfect matches to SUPAWOOD's panel and batten/slat products and the ability to have Fire Retardant beams.



Hoop Pine SF



Fusion Maple SF



Euro Beech SF



White SSV-015



Black SSV-016

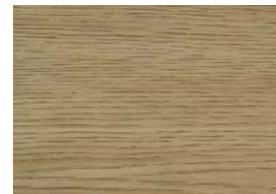

Tasmanian Oak SF

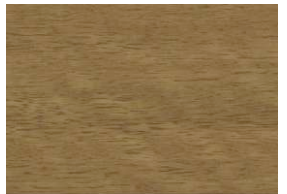

Blackbutt SF



Spotted Gum SF

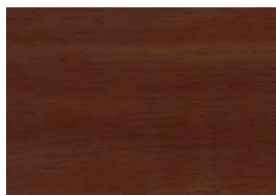

Smooth Mahogany SF

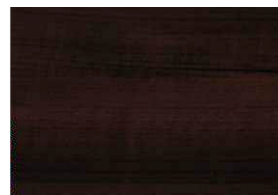

Cracked Cherry SF



OSB SF



Matt Silver SF

All colours shown in these swatches are a guide only and actual will vary from beam to beam. Please note: Colours and specifications may be different in the UK. Please contact the UK office for more information.

# SUPACOLOUR (SCR) 2-pack

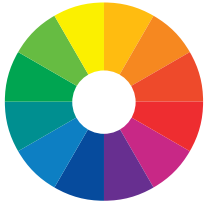

Match to any  
 colour reference

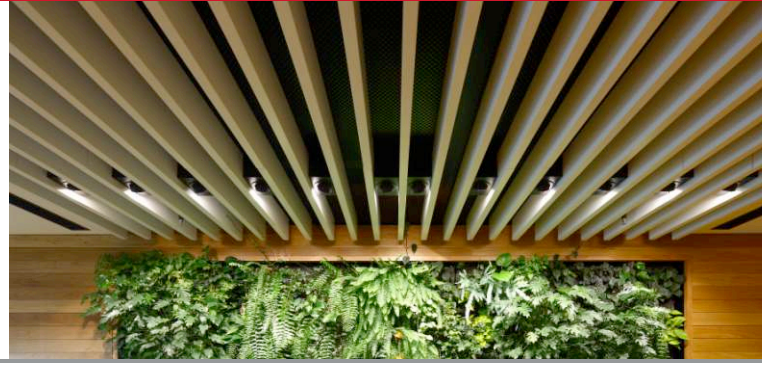

Other custom finishes are available on large projects. Consult our technical staff.

## Finishes Quick Reference Guide

Finish type	Fire Hazard Properties Group Number to BCA clause C1.10	Maximum length in a single piece	Standard sizes - depth x width			* Custom options	
			Small	Medium	Large	Other x 50	Other (e.g. 200 x 200)
SUPALAMI		2775	145x50	195x50	295x50	*	
SUPAVENEER (Non Fire Retardant)		3000	145x50	195x50	295x50	*	
SUPAVENEER (Fire Retardant)		3000	*	*	*	*	*
SUPAFINISH (Non Fire Retardant)		3500	145x50	170x50	270x50	*	*
SUPAFINISH (Fire Retardant)		2900	145x50	170x50	270x50	*	*
SUPACOLOUR (Non Fire Retardant)		2780	145x50	195x50	295x50	*	*
SUPACOLOUR (Fire Retardant)		2900	145x50	170x50	270x50	*	*

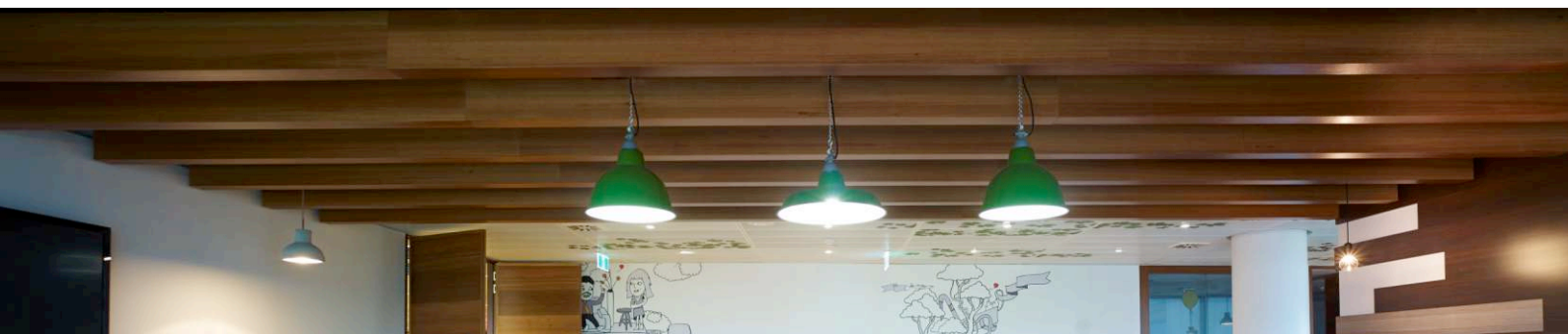

**This page:**

Top - SUPASLAT MAXI BEAM in SUPACOLOUR White used with a wall of plants gives the feel of a pergola garden in the lobby of Sunsuper, Brisbane QLD.

Bottom - SUPAVENEER Tasmanian Oak beams in staggered heights and lengths in a area of Nathan Lion HQ, Homebush NSW.

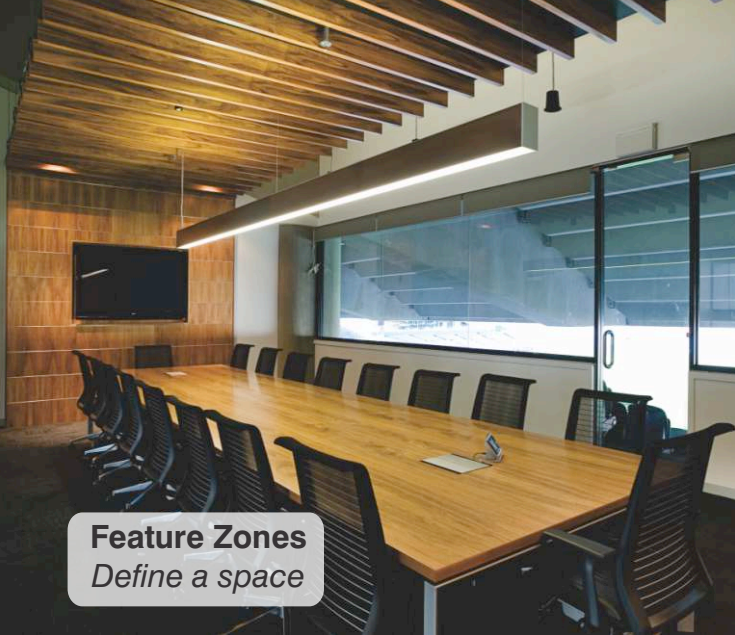

**Feature Zones**  
*Define a space*

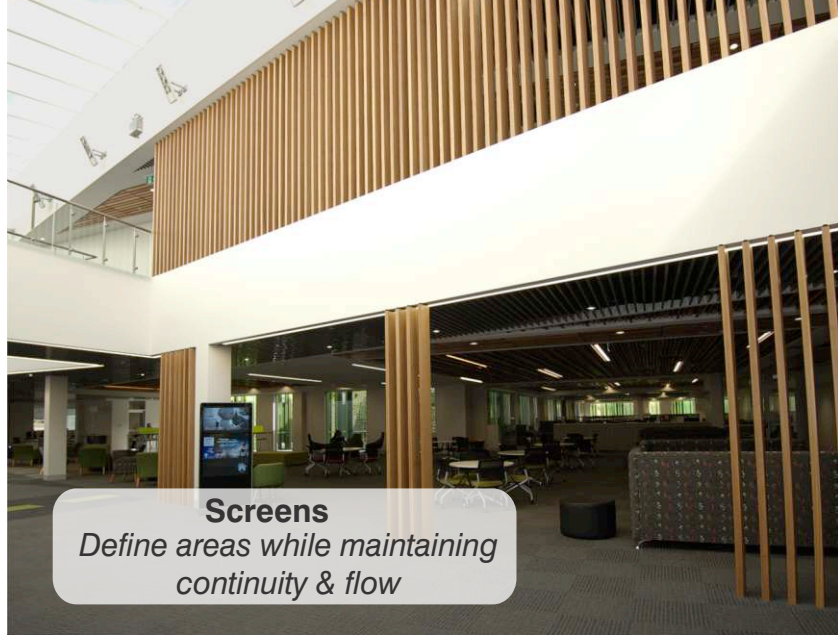

**Screens**  
*Define areas while maintaining continuity & flow*

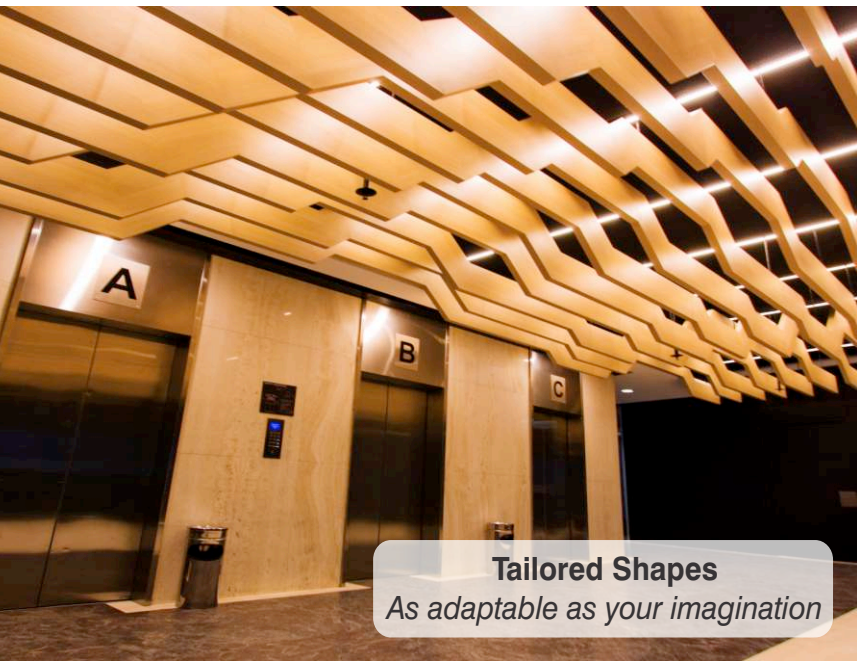

**Tailored Shapes**  
*As adaptable as your imagination*

## MAXI BEAM IDEAS

Adaptable Architectural Tools

Get inspiration and ideas from more than 30 examples of the use of lightweight decorative beams as architectural features.



*Download this great resource...*

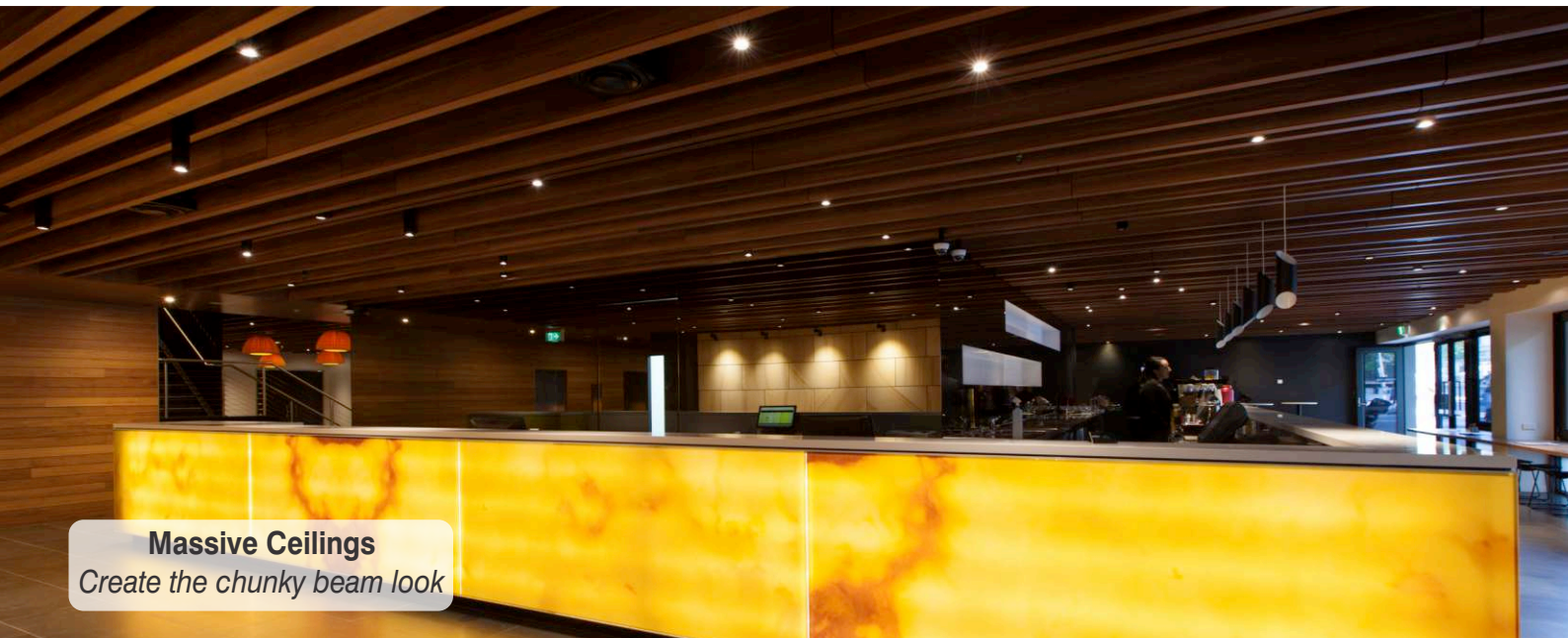

**Massive Ceilings**  
*Create the chunky beam look*

**Top left** - SUPAVENEER Blackwood natural timber veneer at Simonds Stadium, Kardinia Park VIC.

**Top right** - SUPAVENEER Spotted Gum natural timber veneer balustrades and screen - Health & Support Building, TAFE NSW Kingswood Campus.

**Centre** - Contoured beams in SUPALAMI Light Tasmanian Oak laminate at 157 Walker Street, North Sydney NSW.

**Bottom** - Long length beams in SUPALAMI Striped Mahogany in varying heights and spacings at Jasper Hotel, Melbourne VIC.



**Floating Ceiling Features**  
*Create proportion, intimacy & interest*



**Lighting It Up**  
*Integrated lighting to point the way*

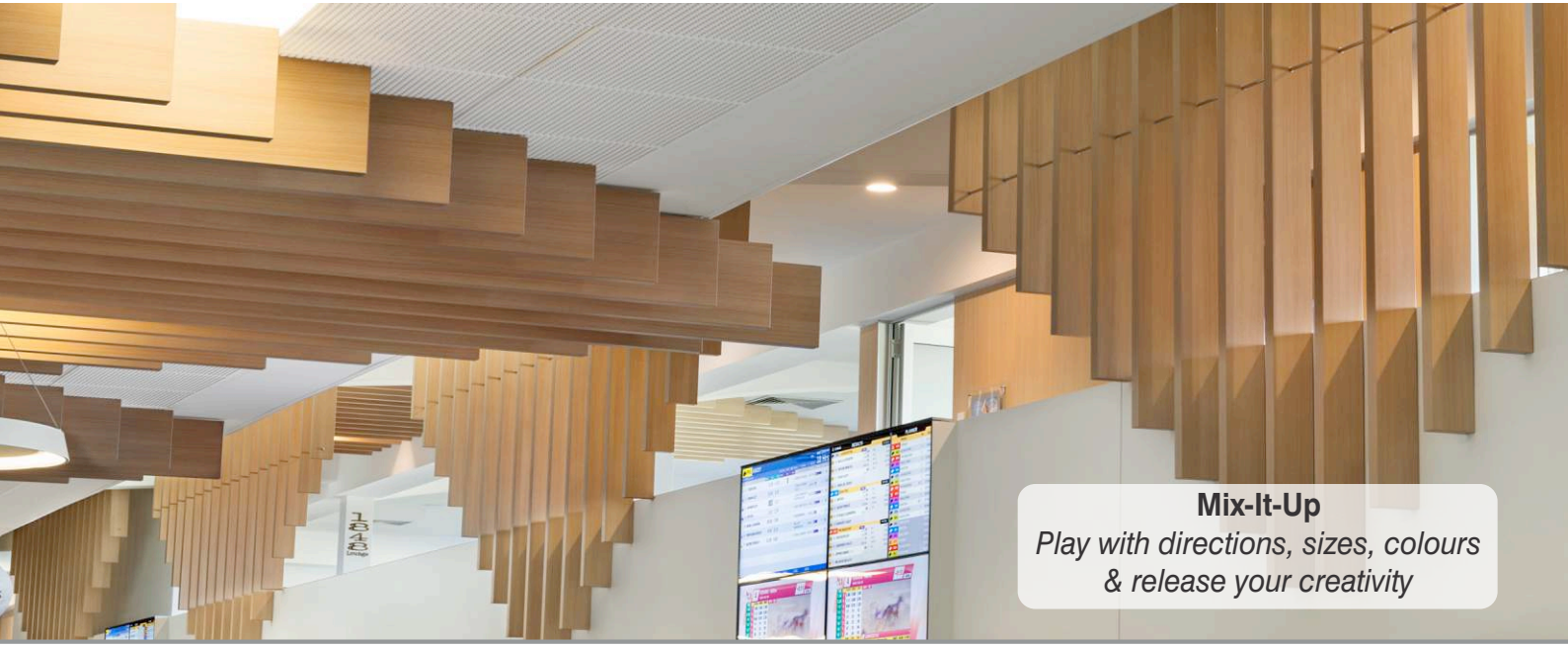

**Mix-It-Up**  
*Play with directions, sizes, colours & release your creativity*

**From top:**

SUPALAMI Light Tasmanian Oak laminate beams form floating rafts on the ceiling of the food hall at Westfields Penrith, NSW.

SUPALAMI Striped Mahogany laminated shaped beams with integrated LED lighting at IGA Romeo's Food Hall, MLC Centre, Sydney NSW.

Staggered SUPALAMI Light Tasmanian Oak laminate ceiling features and screens in the members' areas at Ascot Racecourse, Perth WA.

Supaslat

# MAXI BEAM

What it is...

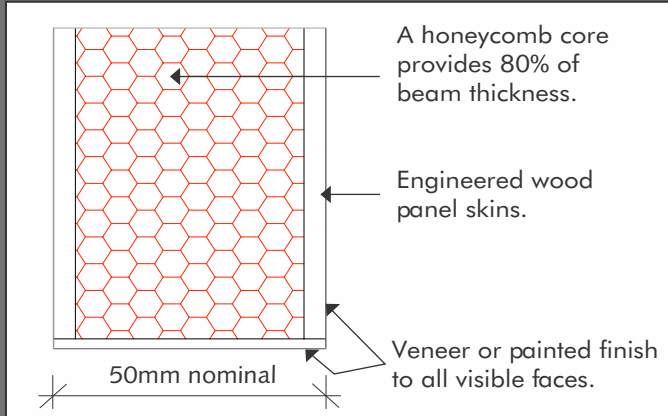

## Suggested Specification Wording

### SUPASLAT MAXI BEAM FEATURE

- ▶ The Ceiling [Wall/Screen] is to be Supaslat MAXI BEAMS by SUPAWOOD Architectural Lining Systems (Phone 1800 002 123).
- ▶ Beams to be [.....] mm deep by [50mm/.....] wide, installed at .....mm centres, extent as shown on drawings.
- ▶ Finish type is to be [SUPAVENEER in... [enter species here].../SUPACOLOUR, colour is to be...[Specify].../SUPALAMI, colour is to be...[Specify].../ SUPAFINISH colour is to be...[Specify].../, SUPASURFACE colour is to be...[Specify]... to all visible surfaces.
- ▶ Beams to be fixed (select one): [direct to existing ceiling / to SUPACOUSTIC panel (specified separately) / SUPABAB 7mm backing boards / to exposed black painted furring channel and top cross rail framing.
- ▶ Installation as per manufacturer's instructions by a sub-contractor accredited by Supawood.
- ▶ Provide engineering certification for any ceiling fixing system.
- ▶ Beams to be Fire Group 3 / 2 / 1 [delete as required] per BCA Specification C1.10 clause 4.  
[Note that fire group 1 is only available in the SUPAFINISH and SUPASURFACE finish type and Group 2 in SUPAFINISH, SUPASURFACE and SUPAVENEER.]
- ▶ Product warranty to be 7 years.

\* Product details are subject to continuous improvement and as such are subject to change.

To download Spec Wording in Word format... [click here](#)

### For more product information:

"Global technology and know-how. Local manufacture and support."

SUPAWOOD produce an extensive range of market-leading lining systems and look forward to helping you on your next project.

Website: [www.supawood.com](http://www.supawood.com)

SUPAWOOD Head Office  
 Australasian Support and Manufacturing  
 Aust. Phone: +61 1800 002 123  
 NZ Phone: +64 (9) 887 3234  
 Email: [sales@supawood.com.au](mailto:sales@supawood.com.au)

SUPAWOOD UK  
 UK & EU Support and Manufacturing  
 Phone: +44 (0) 845 347 0026  
 Email: [sales@supawood.co.uk](mailto:sales@supawood.co.uk)

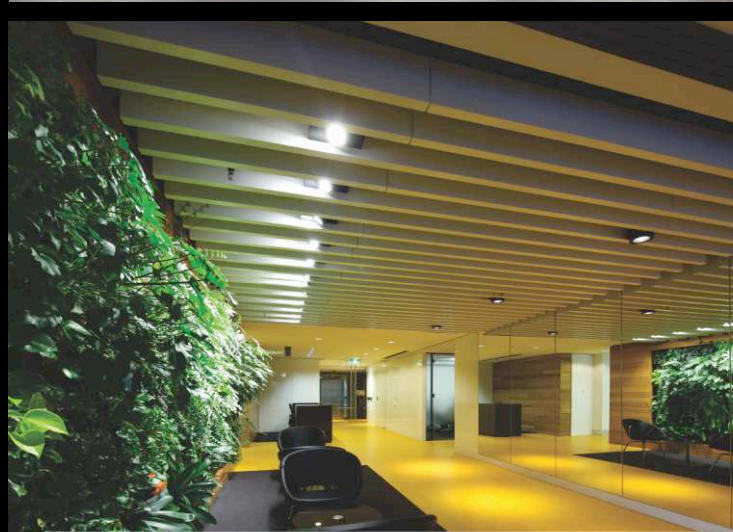

#### Back Cover from top:

SUPALAMI Striped Mahogany floating beams create a sense of space while enabling unrestricted airflow at Trader, Qantas Terminal, Sydney Airport, NSW.

SUPALAMI White, Striped Mahogany and Blackwashed in varying depths create a random ceiling feature in South Headland Shopping Centre, WA.

SUPASLAT MAXI BEAM in SUPACOLOUR White used with a wall of plants gives the feel of a pergola garden in the lobby of Sunsuper, Brisbane QLD.