

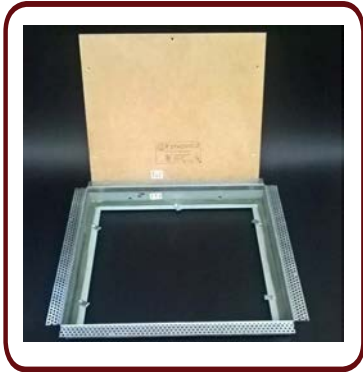

## SP - FYREPANEL - 1 HOUR, SPEEDPANEL ACCESS PANEL

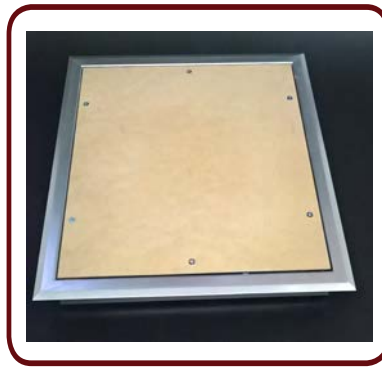

**SETTING BEAD**



**FEATHERED FLANGE**



**2 WAY FIRE RATED**

### GENERAL

The SP- FYREPANEL is a screw fixed fire rated access panel with a laminated MDF or ACP face designed for Speedpanel installations, and to meet the requirements of the BCA. **FRL - /60/60 in both directions.**

### USES

The SP - FYREPANEL is approved for installation in Speedpanel Walls & Shafts, where integrity and insulation are required to be maintained to meet that of the building element requiring access through it. Example: An FRL - /60/60 wall.

### SIZES

**Maximum** size is 1200x700mm.

**Standard sizes are:** 300x300, 400x400, 450x450, 600x600 & 1200x600mm

**Non-Standard** sizes available on request.

### FIRE TEST DATA

The Fyreguard SP - FYREPANEL has been tested and assessed to AS1530.4 to provide an FRL of -/60/60 in both directions. Please contact your nearest Fyreguard office for further information.

### KEY FEATURES

- **Product fit for purpose to meet the requirements of NCC (BCA)**
- **Speedpanel Wall application**
- **Flush Set or Feathered Flange**
- **Simple Installation**
- **Australian Made**
- **Non Standard sizes available**

### SPECIFICATION

Fyreguard SP - FYREPANEL – Screw Fixed FRL -/60/60 fire rated access hatch. Speedpanel wall application. **PH. 07 55934955**

### INSTALLATION

Refer to following Pages of this data sheet for installation instructions or contact your nearest Fyreguard office for assistance.

### ARCHITECTURAL

Refer to following pages of this data sheet for dimensions of the hatch and architectural drawings of frame profile.

**NB: ALL FYREGUARD FIRE RATED ACCESS HATCHES ARE LABELED FOR EASE OF COMPLIANCE AND MAINTAINENCE MAINTAINENCE INSPECTIONS. LABELING IS IN ACCORDANCE WITH FPA GOOD PRACTICE GUIDE AND AS4072.1**

NB: Fyreguard is not responsible if recipients of installation instructions, fire test reports or any relevant literature incorrectly interpret the contents or use products based on those interpretations.

## FYREGUARD SP - FYREPANEL FRL - /60/60

ACCESS HATCHES



## INSTALLATION INSTRUCTIONS:

### 1 HOUR - SP-FYREPANL, 2 WAY, SPEEDPANEL WALL ACCESS PANEL

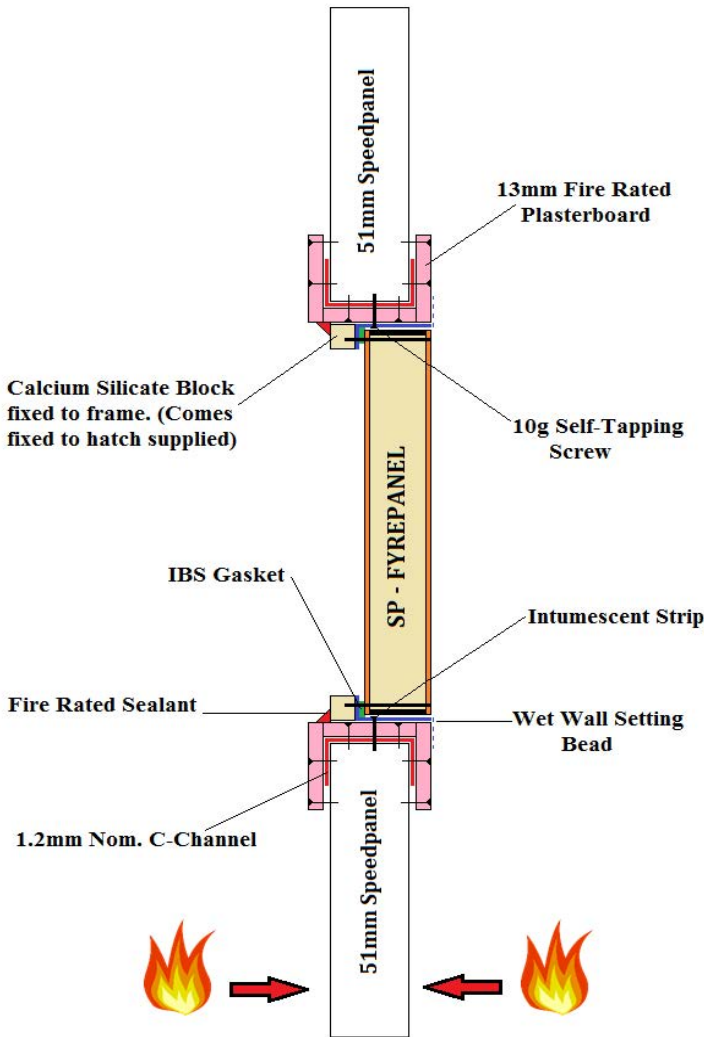

1. Mark out and cut opening in Speedpanel wall approximately 30-32mm larger than hatch frame to allow for trimming of opening.
2. Trim opening in Speedpanel with 80x50mm galvanised Nom.1.2mm C-track. C-track to be fixed with 10g self-tapping screws at 250mm centres, fixings to start no more than 100mm from either end of C-track.
3. Trimmed opening is to be lined with one layer of 13mm fire rated plasterboard using 8g steel screws. One layer of 13mm fire rated plasterboard is also to be installed to each face of the wall and extend a minimum of 100mm from the opening. Alternatively two layers of 13mm FR plasterboard can be installed to side of wall which hatch finishes flush with. Fixings to be in two rows at 150mm centres.

## ARCHITECTURAL DETAIL

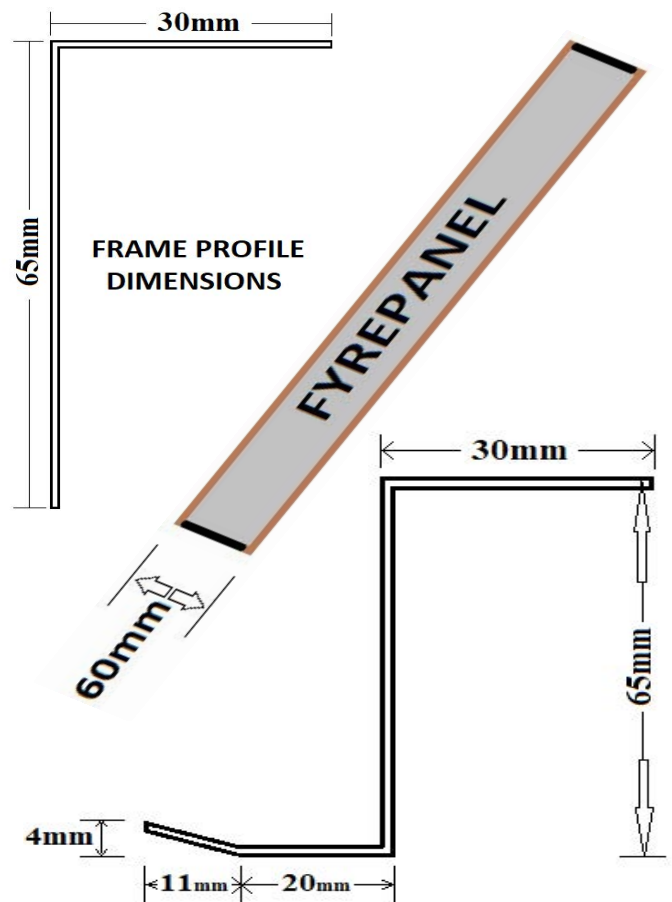

4. Remove panel from frame and install frame into opening using predrilled holes and 10g steel screws. NB: Ensure the frame is temporarily packed out before tightening screws to prevent the frame from distorting. The hatch/panel bolts will not line up with the nuts if distortion occurs. Ensure to remove temporary packers.
5. While the hatch/panel is open apply fire rated mastic sealant to any gaps between the access panel frame and the inside reveal of the opening.
6. Insert hatch/panel into frame ensuring the correct sides line up – refer to identification points on frame and hatch/panel. Engage all panel screws before fully tightening.

**NB: ALL FYREGUARD FIRE RATED ACCESS HATCHES ARE LABELED FOR EASE OF COMPLIANCE AND MAINTAINENCE MAINTAINENCE INSPECTIONS. LABELING IS IN ACCORDANCEWITH FPA GOOD PRACTICE GUIDE AND AS4072.1**

**FYREGUARD SP - FYREPANL FRL -/60/60**



## INSTALLATION INSTRUCTIONS: 1 HOUR - SP-FYREPANEL, 2 WAY, SPEEDPANEL WALL ACCESS PANEL

ACCESS HATCHES

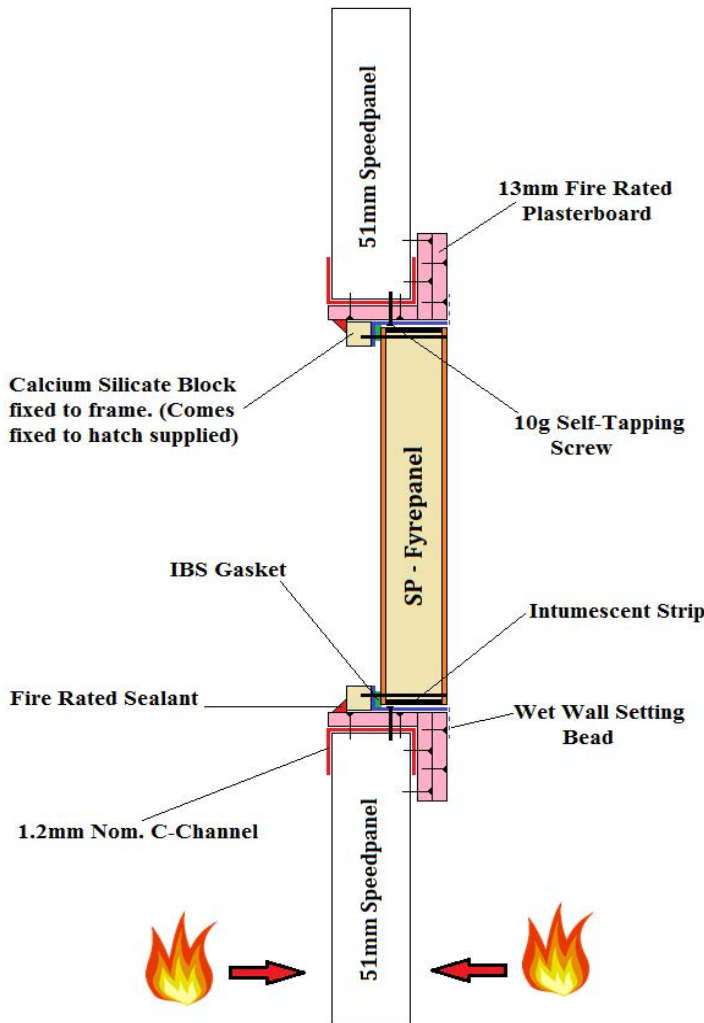

1. Mark out and cut opening in Speedpanel wall approximately 30-32mm larger than hatch frame to allow for trimming of opening.
2. Trim opening in Speedpanel with 75x50mm galvanised Nom.1.2mm C-track. C-track to be fixed with 10g Self-tapping screws at 250mm centres, fixings to start no more than 100mm from either end of C-track.
3. Trimmed opening is to be lined with one layer of 13mm fire rated plasterboard using 8g steel screws. One layer of 13mm fire rated plasterboard is also to be installed to each face of the wall and extend a minimum of 100mm from the opening. Alternatively two layers of 13mm FR plasterboard can be installed to side of wall which hatch finishes flush with. Fixings to be in two rows at 150mm centres.

4. Remove panel from frame and install frame into opening using predrilled holes and 10g steel screws. NB: Ensure the frame is temporarily packed out before tightening screws to prevent the frame from distorting. The hatch/panel bolts will not line up with the nuts if distortion occurs. Ensure to remove temporary packers.
5. While the hatch/panel is open apply fire rated mastic sealant to any gaps between the access panel frame and the inside reveal of the opening.
6. Insert hatch/panel into frame ensuring the correct sides line up – refer to identification points on frame and hatch/panel. Engage all panel screws before fully tightening.

### ARCHITECTURAL DETAIL

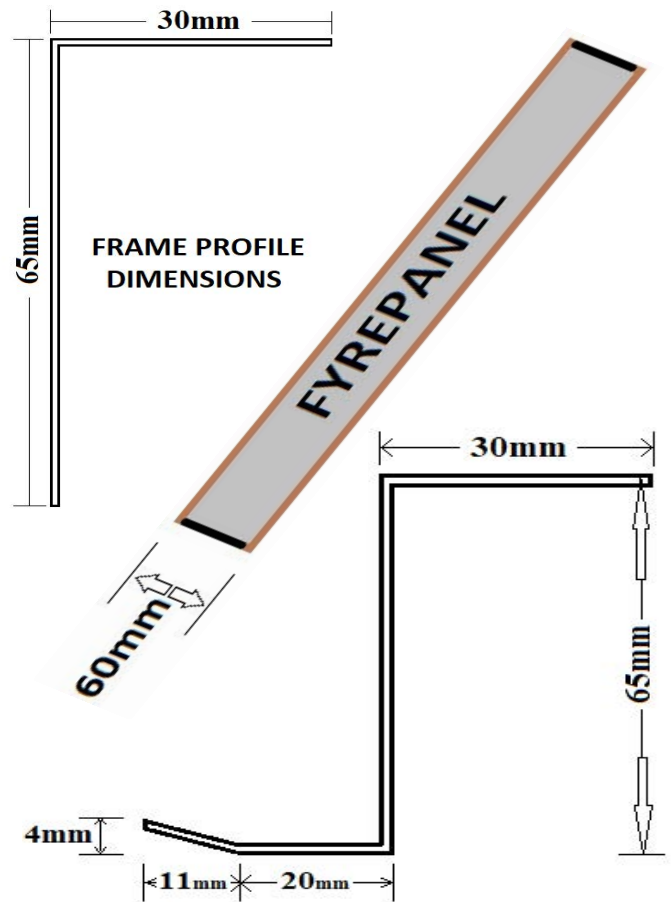

**NB: ALL FYREGUARD FIRE RATED SPEED ACCESS HATCHES ARE LABELED FOR EASE OF COMPLIANCE AND MAINTAINENCE MAINTAINENCE INSPECTIONS. LABELING IS IN ACCORDANCE WITH FPA GOOD PRACTICE GUIDE AND AS4072.1**

**FYREGUARD SP - FYREPANEL FRL - /60/60**