

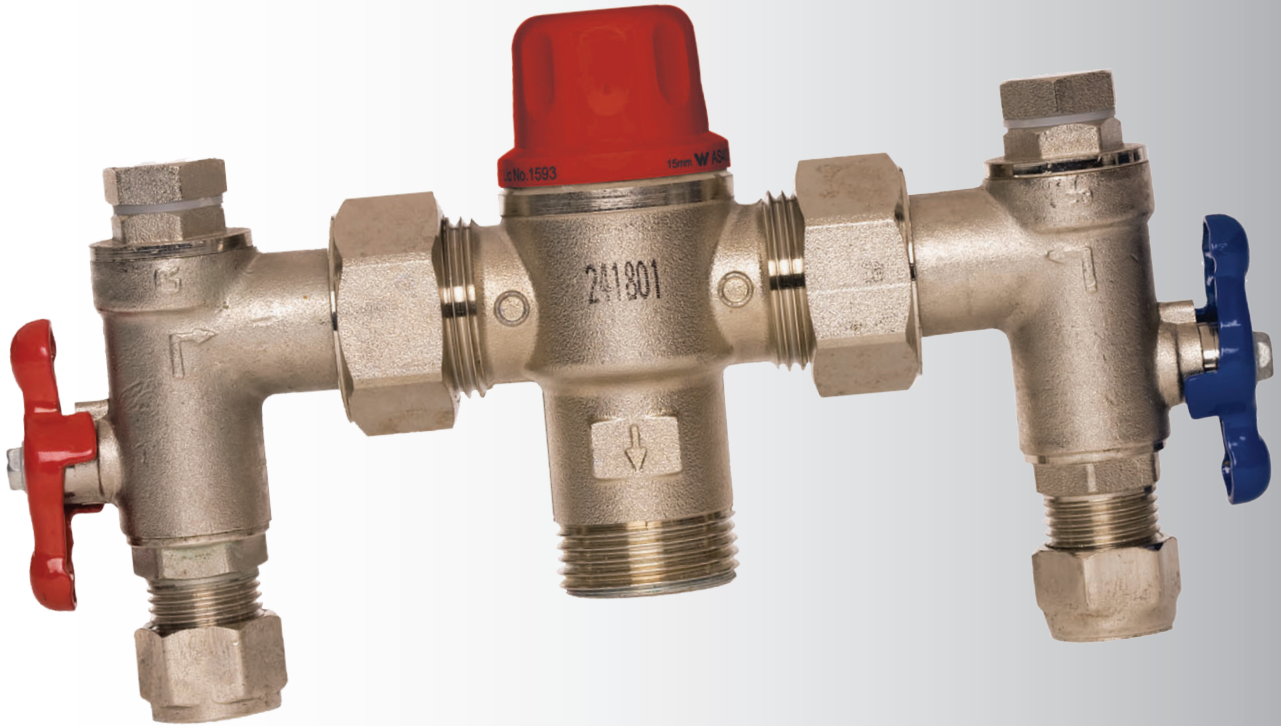

installing **confidence**



AQUABLEND™ 1500 with Thermal Flush

A major step forward
in Legionella control

coming soon

AQUABLEND™ 2000

Thermal Flush

Retrofit Cartridge

AQUABLEND™ 1500

with Thermal Flush

Australia's leading TMV brand now with Thermal Flush allowing a controlled hot water flush to pass through the TMV for maintenance and decontamination

WHAT HAS CHANGED?

- The lock shield (cap) is now red and has "Thermal Flush" in the text
- Thermal Flush Procedure is outlined in a new booklet supplied with each valve
- A maximum temperature of 50°C can now be set

WHAT IS UNCHANGED?

- Australian Made
- The Aquablend™ 1500 will function as normal if the thermal flush is not used
- Watermark Certification AS4032.1 and NSW Health Approved
- Product codes for the Aquablend™ 1500 and cabinet combinations remain

UPGRADES

With the release of the New Aquablend™ 1500, all existing* Aquablend TMV's can now be upgraded to include Thermal Flush. A comprehensive new service kit has been released under the new part ID/Code ATMS242

SERVICE KIT

All service kits for Aquablend 1000, 1500 and 2000 TMV's will be supplied with the ATMS242 "Upgrade Kit" the lock shield will be marked "upgrade" so it is identifiable after it has been installed

An updated new part/price table will be released for service kits and spare parts for all Aquablend™ branded products.

SERVICE KIT WILL INCLUDE

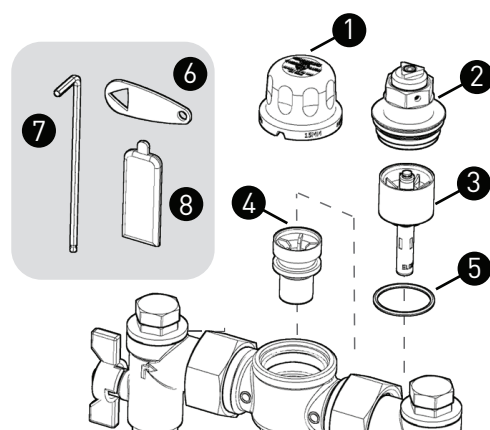

- | | |
|-----------------------------|------------------------------|
| ① Red Lock Shield | ⑤ O-ring (Body O-ring) |
| ② Top Cap Assembly | ⑥ Temperature Adjustment Key |
| ③ Element & Piston Assembly | ⑦ Allen Key |
| ④ Mixing Tube | ⑧ Grease |

See how it works
bit.ly/thermalflush