

TA12

series



Product Segments

• Care Motion

Patient lifts need to focus on safety, reliability and effortless operation. This is why we create our actuator-TA12 which will fulfill what nurses and patients need while trying to move a patient from the bed to a wheelchair or from the wheelchair to the toilet. Additionally, TA12 is also suitable for bariatric beds, which will meet the needs of the caregivers and patients themselves. Especially, there are several challenges that bariatric beds could face, such as turning and repositioning to prevent pressure sores, transferring in and out of a bed or chair, assisting with bathing and toileting, and supporting a limb while performing patient handling tasks...etc.

One of its significant features is TA12 has manual release function that can turn the inner tube down by hand, in case of emergency, or if electrical power is not available.

General Features

Voltage of moto	12V DC, 24V DC , or 36V DC
Maximum load	12,000N in push
Maximum load	6,000N in pull
Maximum speed	57.0mm/s
Minimum installation dimension	stroke+210mm
Color	black or grey
Protection class	IP54 or IP66
Certificate	UL/EN60601-1
Option	safety nut, Hall/Reed/POT sensor(s), manual release



P: 07 3297 9797 | E: info@techome.com.au | W: www.techome.com.au

We can control and automate ANYTHING

Drawing

Standard Dimension

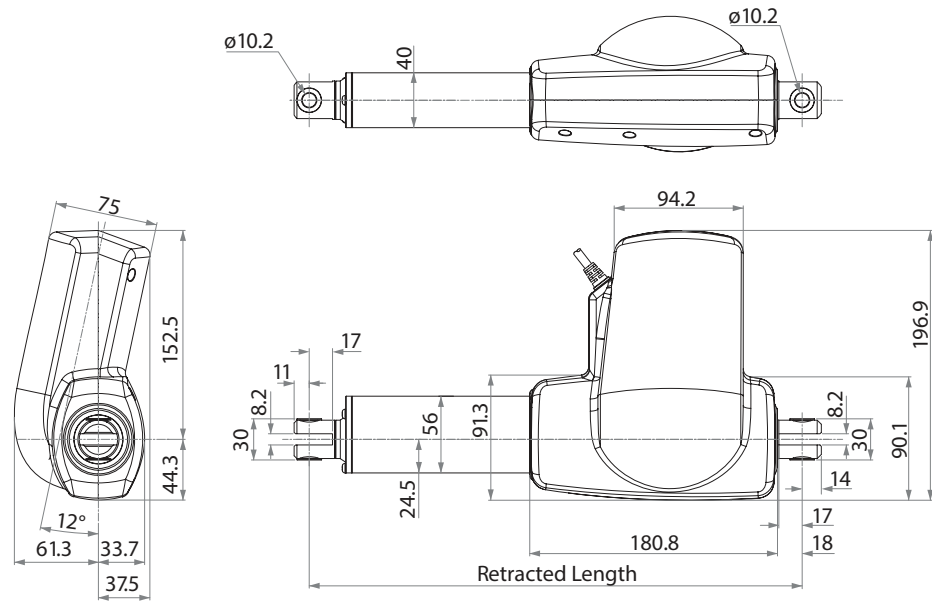

Load and Speed

CODE	Rated Load		Self Locking N (PUSH)	Typical Current at Rated Load (A)	Typical Speed	
	PUSH N	PULL N			No Load (32V DC) mm/s	Rated Load (24V DC) mm/s

Motor Speed (4000RPM)

A	10000	6000	10000	13.0	14.0	6.5
B	12000	6000	12000	8.5	7.0	4.0
C	7000	6000	7000	8.5	14.0	8.0
D	4000	4000	4000	8.5	28.0	16.0
E	3000	3000	3000	8.5	43.0	24.0
F	2000	2000	2000	8.5	57.0	32.0

Stroke with POT Sensor

CODE	Max. Stroke	Lead of The Thread	Starts of Spindle	Resolution Ω/mm
A	335	3.9	1	27.97
B	335	3.9	1	27.97
C	685	4	2	13.64
D	685	4	2	13.64
E	1030	4	3	9.09
F	1500	4	4	6.82

Note

- 1 The left diagram shows the speed and current figures under pushing condition.
- 2 Speed would be the same if with 12V motor, but with double current consumption.
- 3 When customer chose load & speed "code #A", they cannot choose voltage option "#1_12V"

Terms of Use

The user is responsible for determining the suitability of Techome products for a specific application.

Due to continuous development in order to improve our products, Techome products are subject to frequent modifications and changes without prior notice.

Techome reserves the right to discontinue the sale of any products displayed on its website or listed in its catalogue or other written materials drawn up by Techome.