



FireMaster®

Fire Rating

Max Width

Max Height

- / 240 / -

30 metres

9 metres

- / 120 / -

30 metres

6 metres

FireMaster®

FireMaster® is an uninsulated active fire curtain barrier that vertically protects openings in fire rated walls or can be used to completely replace non-load bearing fire rated walls. To protect means of escape or where there are combustibles in close proximity see FireMaster® Plus.

FireMaster® Fire Curtains are designed as barriers to prevent the spread of fire in accordance with AS1530.4.

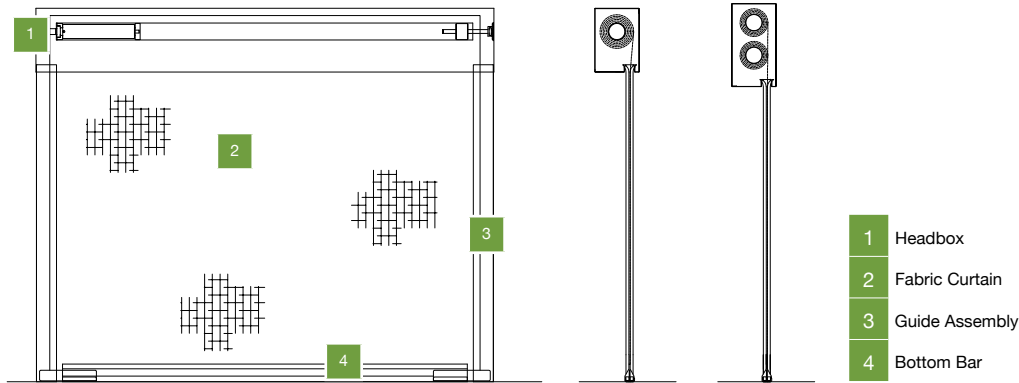

Barrier Construction

Each roller is up to 5m wide with multiple roller construction up to 30m wide. Wide Single Roller (WSR) construction is available up to 17m wide.

Material Finish

Metalwork is zinc coated mild steel. This can be painted on site or powdercoated to DULUX or RAL colours.

Operation

A 24v electromagnetic brake holds the fire curtain open. Closing is by gravity at a controlled speed of 0.06 - 0.15m/s. Opening is driven by one or more 24vDC tubular motors mounted within the barrel.

Test / Reset

Test is performed by a simple key switch operator. The system is reset manually by pressing the reset button on the control panel. Automatic reset is available.

Benefits

- Small lightweight headboxing
- Can fire protect very large open spaces without the need to heavy structural supports
- Can easily retrofit into heritage buildings
- Is true Fail-Safe by gravity which means it will work when required
- Patented TOTAL fail-safe by gravity which means it will work when required

Fabric

The curtain material is a satin weave fibreglass fabric with a silver polyurethane coating on both sides and integral stainless steel wire. It is 0.54mm thick, and weighs approximately 690g/m² in its finished form.

Fire Rating

Up to 4 hours fire integrity to AS1530.4. Assessment report EXOVA EWFA-RIR-21553

Incident Irradiance (kW/m²)

Time (mins)	I ₀ - 0mm	I ₁₀₀₀ - 1,000mm
0	0.00	0.00
15	16.32	12.00
30	23.12	17.00
60	32.64	24.00
120	48.97	36.00

Bottom Bar

Standard bottom bar is Jumbo which is a triangular shaped bar 40mm wide. Also available is the 'T' bar and operable ceiling interface systems (SLAT) in 150mm and 75mm profiles



coopers

EST. 1983