



Supaslat

MAXI BEAM

Lightweight Beam System

- Simple, bold and attractive
- Light-weight & rigid - no twisting
- Environmentally preferable

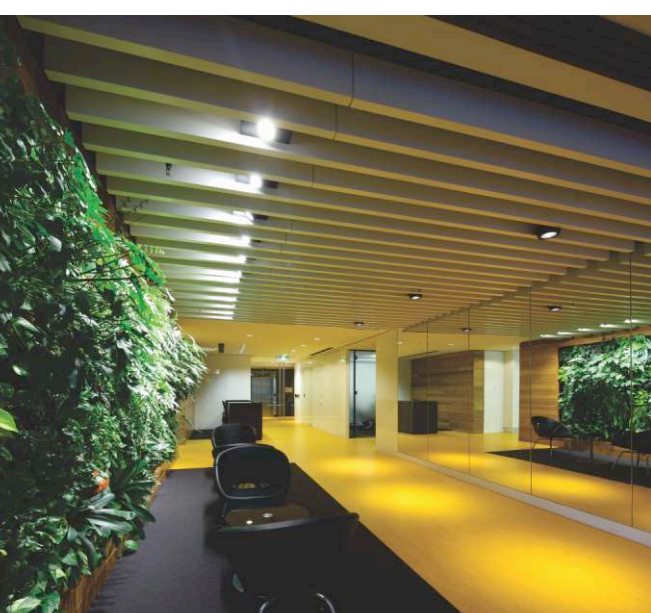
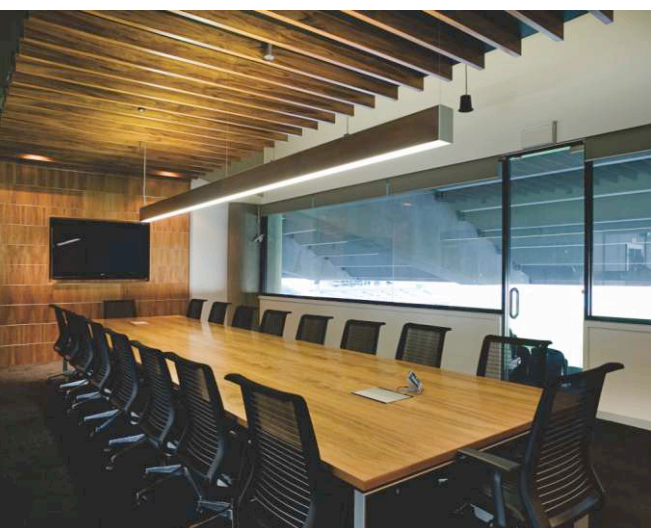
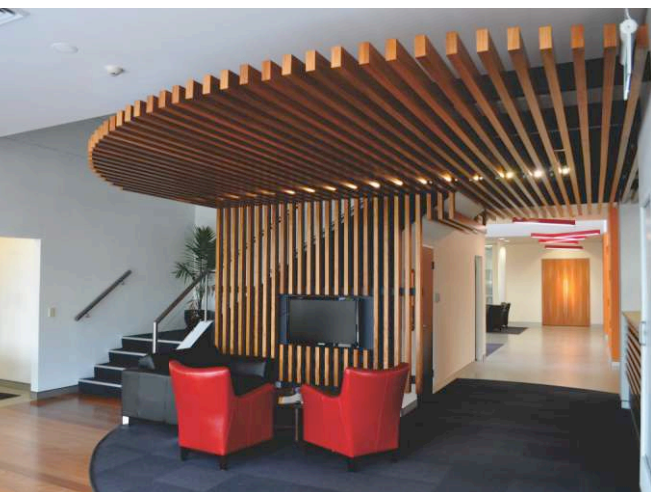

Supaslat MAXI BEAM

Lightweight Beam System

Beams that provide maximum impact while being quick and simple to specify and install!

✓ Environmentally Sustainable

SUPASLAT MAXI's honeycomb core (over 80% of the panel thickness) is 100% post consumer recycled paper waste. The MDF outer layer is low formaldehyde and are sourced from well managed forests.

✓ Light Weight

SUPASLAT MAXI weighs only around 2kg/LM for a 200mm deep beam. This relieves the support structure of undue load and obviates the need for specially engineered framing.

✓ Dimensional Stability

SUPASLAT MAXI will not warp or twist as is experienced with solid timber. The honeycomb core provides extreme rigidity and impact resistance and facilitates increased cantilevers.

✓ Acoustics

SUPASLAT MAXI is in itself acoustically diffusive, acting as a baffle. Acoustic absorption can be achieved by installing the beams under a perforated SUPACOUSTIC ceiling or SUPABAB Black acoustic backing boards. Refer to Supawood for detail drawings of backing options.

✓ Fixing Methods

SUPASLAT MAXI engineer certified fixing system includes fixing cleats and installation instructions to suit fixing to an open suspended frame, a suspended ceiling, walls or as a screen from floor to ceiling. SUPASLAT can be fixed at 1200mm centres or more, reducing framing cost substantially.

Please note: colours and specifications may be different in the UK. Please contact the UK office for more information.

Finish Options

SUPA VENEER Natural Timber Finishes

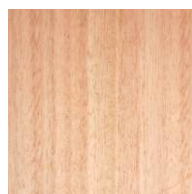

Tasmanian Oak 1/4

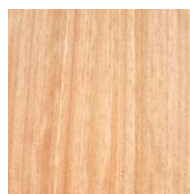

Blackbutt

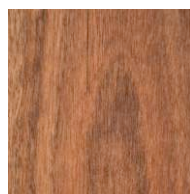

Spotted Gum

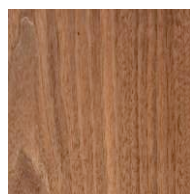

American Walnut

SUPA VENEER
can also be
produced in any
veneer species *

SUPA COLOUR 2-pack



SUPA COLOUR
can be matched to
any paint colour
reference *

* This means the finish can match other surfaces as required.

SUPA LAMI Laminate Finishes to meet your budget



White 2000

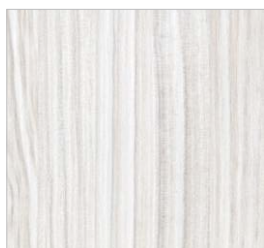

Rustic White

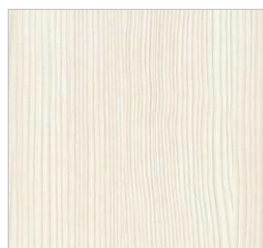

Limed Poplar

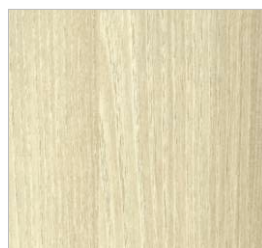

Limed American Oak

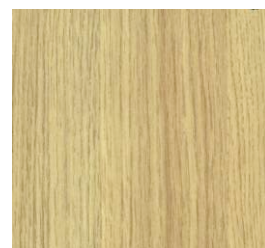

Light Tas Oak

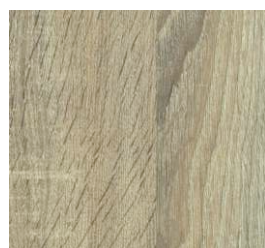

Rustic Oak

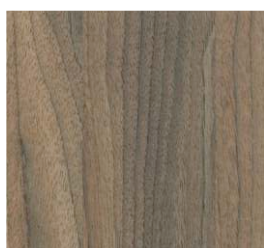

Brown Walnut

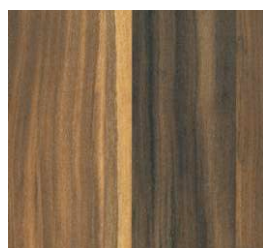

Striped Mahogany

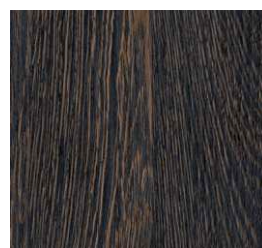

Burnt Timber

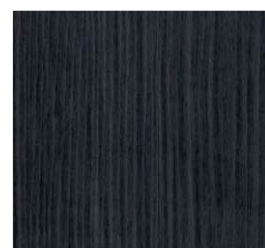

Rustic Black

All colours shown in these swatches are a guide only and actual will vary from beam to beam.

Size Options

- ▶ SUPASLAT MAXI is supplied cut to length and with all visible faces finished in 3 standard depths of 147, 197 and 297mm.
- ▶ Beams can be supplied in any length up to 2780 long (SUPALAMI and SUPA COLOUR) or 2695 long (SUPA VENEER) and are simple to join on site for longer lengths.
- ▶ Local manufacture means custom beam depths or tapered beams can be easily achieved.

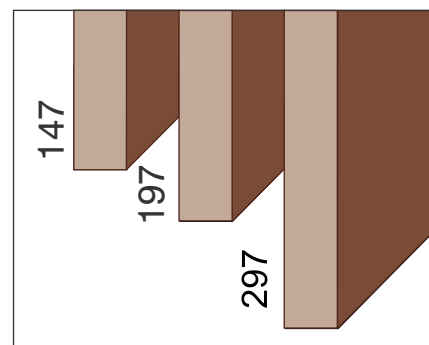

Supaslat

MAXI BEAM

What it is...

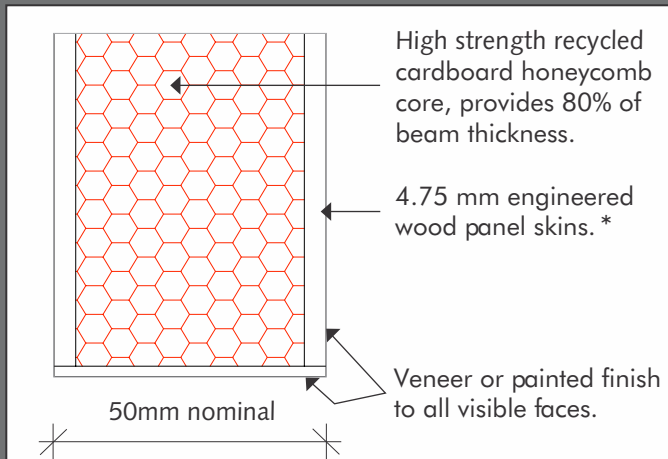

Suggested Specification Wording

SUPASLAT MAXI BEAM FEATURE

- ▶ The Ceiling [/Wall/Screen] is to be SUPASLAT MAXI Beams by SUPAWOOD Architectural Lining Systems (Phone 1800 002 123).
- ▶ Beams to be [147/197/297/custom.....] mm deep, installed atmm centres, extent as shown on drawings.
- ▶ Finish type is to be [SUPA VENEER in... [enter species here].../SUPACOLOUR, colour is to be...[Specify]...]/SUPALAMI, colour is to be...[Specify]...to all visible surfaces.
- ▶ Beams to be fixed (select one): [direct to existing ceiling / to SUPACOUSTIC panel (specified separately) / SUPABAB 7mm backing boards / to Exposed Black SUPATILE GRID framing.
- ▶ Installation as per manufacturer's instructions and engineer certified fixing system by a sub-contractor accredited by Supawood.
- ▶ Beams to be Fire Group 3 as per BCA Specification C1.10 clause 4.
- ▶ Product warranty to be 7 years.

* Product details are subject to continuous improvement and as such are subject to change.

To download Spec Wording in Word format... [click here](#)

For more product information:

"Global technology and know-how. Local manufacture and support."

SUPAWOOD produce an extensive range of market-leading lining systems and look forward to helping you on your next project.

Website: www.supawood.com

SUPAWOOD Head Office

Australasian Support and Manufacturing

Phone: +61 1800 002 123

Email: sales@supawood.com.au

SUPAWOOD UK

UK & EU Support and Manufacturing

Phone: +44 (0) 845 347 0026

Email: sales@supawood.eu



Front Cover:

SUPASLAT MAXI BEAM in SUPA VENEER American Oak over SUPACOUSTIC panel makes an office staff room quiet, warm and welcoming.

Back Cover from top:

SUPALAMI Striped Mahogany floating beams creates a sense of space while enabling unrestricted airflow for an airport store.

SUPALAMI White, Striped Mahogany and Blackwashed in varying depths create a random ceiling feature in a shopping centre.

Inside left from top:

SUPASLAT MAXI BEAM under SUPACOUSTIC panels creates a warm atmosphere and the quiet required in a hospital learning centre library.

Used here in SUPA VENEER Blackwood as a suspended floating ceiling and wall screen to creates a striking statement in the entrance of a sporting body HQ.

SUPASLAT MAXI BEAM In SUPA VENEER Blackwood echos the table in a corporate boardroom.

SUPASLAT MAXI BEAM in SUPACOLOUR White used with a wall of plants gives the feel of a pergola garden in a corporate lobby.

Inside right:

SUPASLAT MAXI BEAM as a bold statement in a corporate lift lobby.